



REVOLUTION™

4 BURNER



FLARE FREE
TECHNOLOGY™

ASSEMBLY MANUAL

G53235

LIMITED 5-YEAR WARRANTY

Read and save manual for future reference.

Assemble your barbecue immediately. Missing or damaged parts should be claimed within 30 days of purchase.

For product inquiries, parts, warranty and troubleshooting support, please call 1300 659 489.



AGA 9138G



HEAVY ARTICLE NEEDS 2 TO LIFT

THIS MANUAL MUST REMAIN WITH THE PRODUCT AT ALL TIMES

To ORDER non-warranty replacement parts or accessories,
or to register your warranty, please visit us on the web at
www.colemanbbqs.com.au

⚠ CAUTION

Sharp edges. Wear gloves when assembling your barbecue.

⚠ CAUTION

It is recommended that you carefully read and adhere to all safety statements, assembly instructions, and care to directions prior to undertaking any assembly or cooking tasks.

⚠ INSTALLER OR ASSEMBLER/ CONSUMER

This manual should be kept with the barbecue at all times.

⚠ WARNING

Failure to follow all of the Manufacturer's instructions could result in hazardous fires, explosions, property damage, or serious personal injury or even death.

Follow all leak check procedures carefully prior to operation of barbecue, even if grill was dealer assembled. Do not try to light this barbecue without reading the Lighting Instructions section of this manual.

⚠ DANGER

1. If you smell Gas:
 - a. Shut off gas to the appliance
 - b. Extinguish any open flame
 - c. Open lid
 - d. If odor continues, keep away from the appliance and immediately call your gas supplier or your fire department
2. Requires two people to complete the assembly process.
3. Beware of sharp edges.

⚠ WARNING

1. Do not store or use gasoline, vapours, or any other flammable liquids in the vicinity of this appliance.
2. An LP cylinder not connected for use shall not be stored in the vicinity of this or any other appliance.

⚠ WARNING

WHEN EXPOSED TO DIRECT SUNLIGHT AND DURING OPERATION, THE STAINLESS STEEL AND PAINTED STEEL COMPONENTS OF YOUR BARBECUE CAN REACH HIGH TEMPERATURES.

THIS BARBECUE IS FOR OUTDOOR USE ONLY

**CONTACT CALL CENTRE IF ANY PARTS ARE MISSING
1300 659 489**

HARDWARE PACK

TOOLS NEEDED FOR ASSEMBLY

- #2 Phillips screwdriver (long and short)
- 1/4" Slotted screwdriver (long and short)
- Adjustable wrench
- Pliers

No.	Description	Part Number	Qty.
1	1/4"-20UNCx38 Screw	20120-13038-250	6
2	1/4"-20UNCx16 Screw	20120-13016-250	30
3	NO.10-24UNC x13 Screw	20124-10013-250	19
4	ST4.8X10 Tapping Screw	22500-48010-810	2
5	NO.8-32 X 3/8, Philips Flat Head	20332-08010-250	3
6	ST4.2X10 Tapping Screw	22500-42010-137B	15
7	φ7 Fiber washer	G501-0054-9100	10
8	1/4"-20UNC Flange Nut	31220-13000-250	2
9	NO.10-24UNC Flange Nut	31224-10000-250	1
10	M4 Wing Nut	33301-04000-032	1
11	Venturi Clip, Side Burner	G405-0019-9200	1
12	Wheel Lock Pin	G350-0026-9000	1

⚠ Caution:
Sheet metal can cause injury. Wear gloves when installing the barbecue.

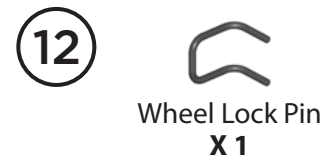
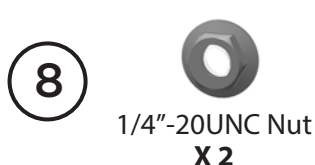

BEFORE ASSEMBLING THIS BARBECUE, READ THE INSTRUCTIONS CAREFULLY.

Assemble the barbecue on a flat, clean surface. Grill is heavy. Two people are recommended to assemble this barbecue.

PARTS LIST FOR G53235

Item No.	Qty.	Description	Part No.
AA	1	Top Lid Assembly	G532-G500-01
AB	1	Lid Handle	G532-0056-01
AC	1	Thermometer	G363-0035-01
AD	1	Thermometer Bezel	G532-0006-01
AE	2	Screw, Top Lid	G466-0007-01
AF	2	Lid Bumper, Front	G527-0002-02
AG	2	Lid Bumper, Rear	G303-0038-01
BA	1	Burner Box Assembly	G532-2700-01
BB	4	Main Burner	G532-K200-01
BC	4	Carryover Assembly	G614-0095-01
BD	4	Heat Distribution Plate	G532-0016-01
BE	1	Grease Channel	G532-0015-01
BF	4	Cooking Grate	G532-0017-02
BG	1	Cleaning Tool	G532-0049-01
BH	1	Warming Rack	G532-0018-01
BI	1	Match Holder	G501-0068-01
BJ	1	Grease Channel Shield	G532-0063-01
BK	4	Main Burner Brace	G466-0047-01
BL	1	Hotplate	G532-0088-01
CA	1	Manifold Assembly	G532-G400-01
CB	1	Regulator	G532-0086-01
CC	1	Side Stove Valve	G532-0085-01
CD	1	Metal Hose, Side Stove	G401-0068-01
CE1	1	Electronic Ignition Assembly	G532-0019-0A
CE2	1	Ignition Battery Cover	G532-0019-02
CE3	1	Instastart™ Ignition Button	G532-0082-01
CF	1	Electrode Set, Main Burner	G515-0067-01
CG	5	Control Knob	G532-3600-01
CH	5	Knob Bezel	G363-0026-01
CI	1	Control Panel	G532-0087-01
CJ	1	Front Brace	G532-9000-01
CK	1	Grease Cup - Burner Box	G416-0015-01
CL	2	Grease Cup Rails	G466-0034-01
CM	1	Upper Back Panel	G532-0022-01
CN	1	Lower Back Panel	G532-0090-01
CO	1	Heat Shield - Burner Box	G532-0023-01
CP	1	Tank Exclusion Wire	G532-0077-01

Item No.	Qty.	Description	Part No.
DA	1	Side Stove Side Shelf, Left	G532-0900-01
DB	1	Side Shelf Fascia, Left	G532-H200-01
DC	1	Side Shelf Table Rear Brace, Left	G532-1300-01
DD	1	Side Stove Burner	G532-1400-01
DE	1	Side Stove Support Drip Pan	G515-0083-03
DF	1	Electrode Set, Side Stove	G515-0039-02
DG	1	Side Stove Lid	G532-0029-01
DH	1	Side Stove Cooking Grate	G501-0077-01
DI	1	Side Shelf Table, Right	G532-0092-01
DJ	1	Side Shelf Fascia, Right	G532-H400-01
DK	1	Side Shelf Table Rear Brace, Right	G532-1700-01
DL	1	Grease Cup Holder - Flare-Free	G532-0031-02
DM	1	Grease Cup - Flare-Free	G532-0031-02
EA	1	Cart Side Panel, Left	G532-G800-01
EB	1	Cart Side Panel, Right	G532-G900-01
EC	1	Left Door Assembly	G532-9100-01
ED	1	Right Door Assembly	G532-9200-01
EE	2	Door Handle	G532-0026-01
EF	1	Bottom Shelf	G532-G700-01
EG	2	Locking Castor	G350-0023-01
EH	2	Castor	G350-0024-01
EI	2	Door Magnet Assembly	G527-0037-01
EJ	1	Left Heat Shield	G532-0093-01
EK	1	Right Heat Shield	G532-0094-01
EL	1	Ignition Box Cover	G363-0040-01
F1	1	Hardware Pack	G532-B035-01
F2	1	Assembly Manual	G532-M035-01
F3	1	Safe Use and Care Manual	G363-M023-02
F4	2	Gas Bottle Support	G362-0060-01

EXPLODED DIAGRAM FOR G53235

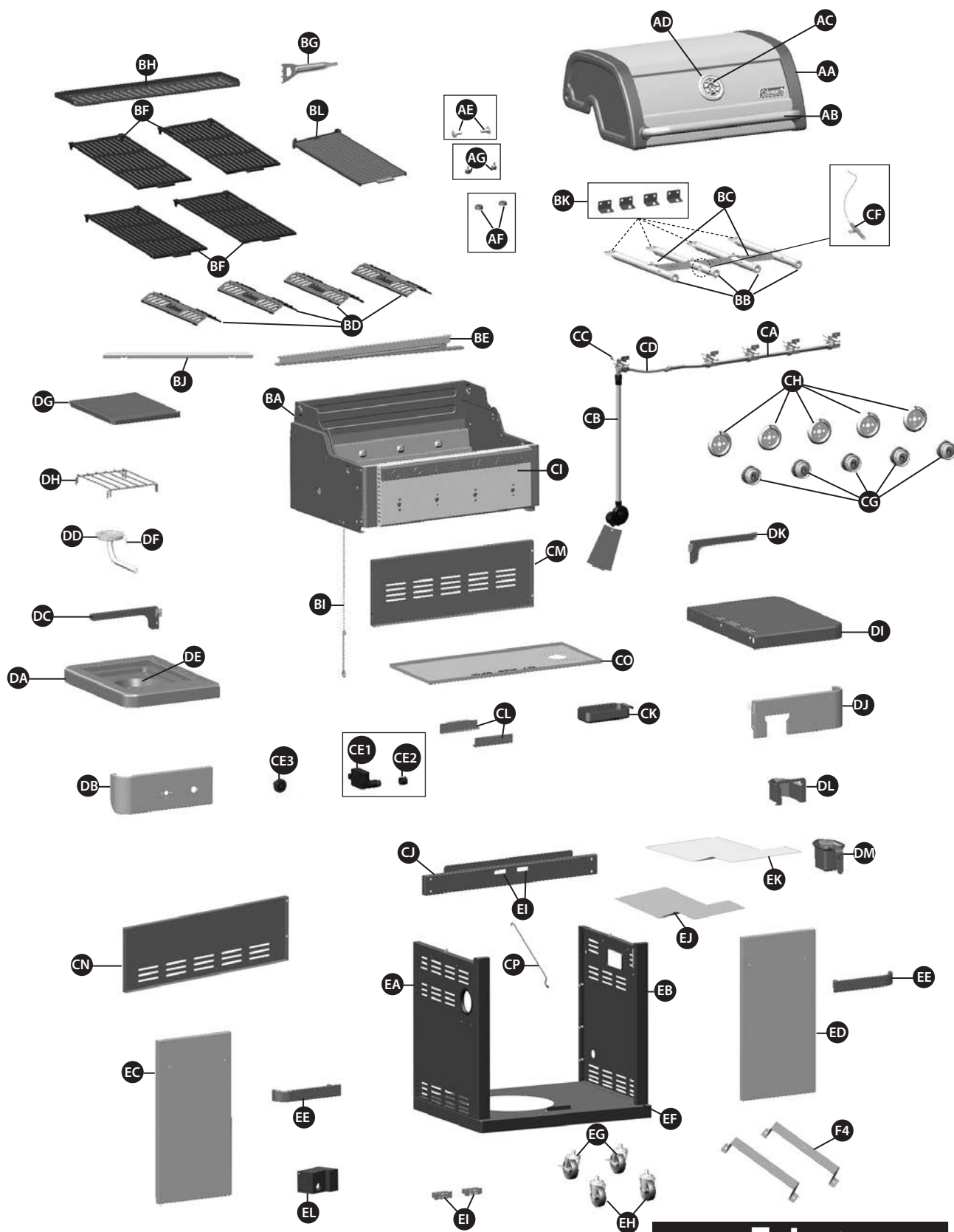

Extras

Hardware
Pack
F1

Assembly
Manual

F2

Safe Use
& Care
Manual

F3

ASSEMBLY INSTRUCTIONS

1

TIP:

One time assembly tool.

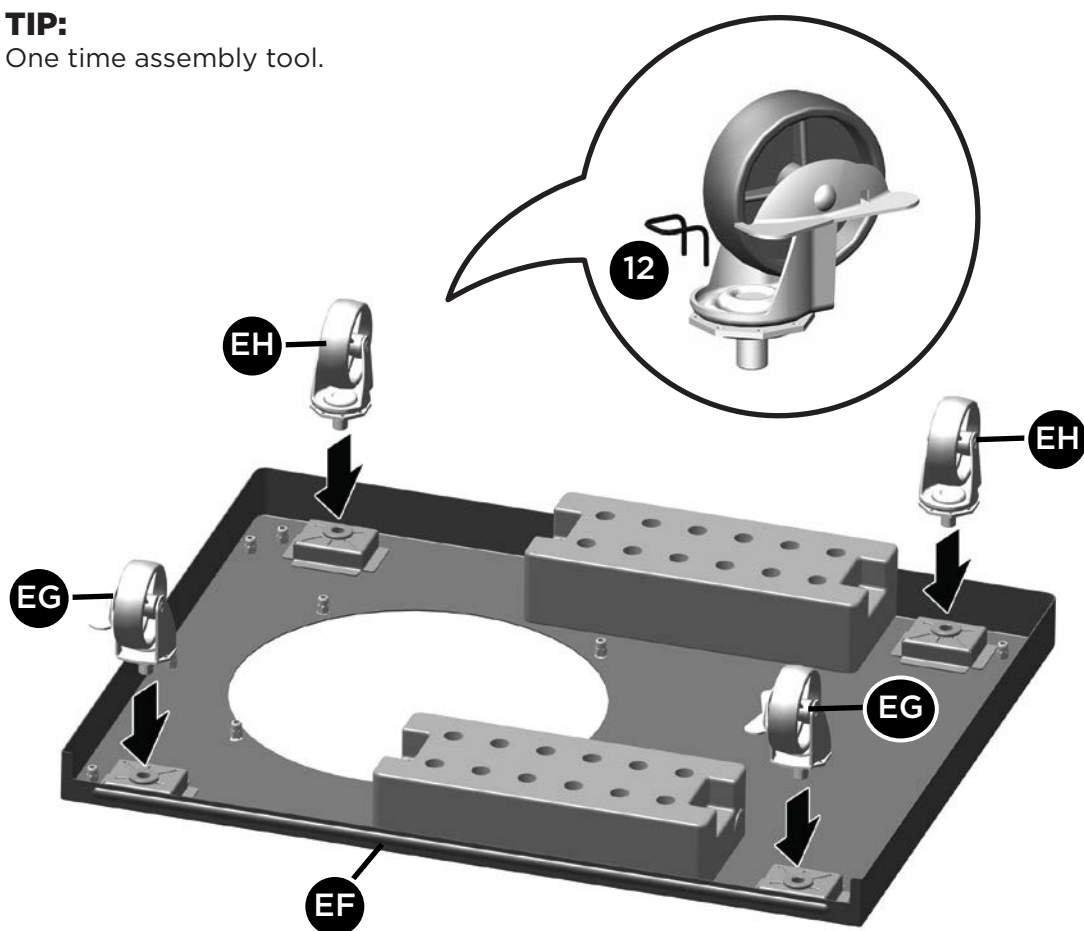

View from the back.



ASSEMBLY INSTRUCTIONS

2

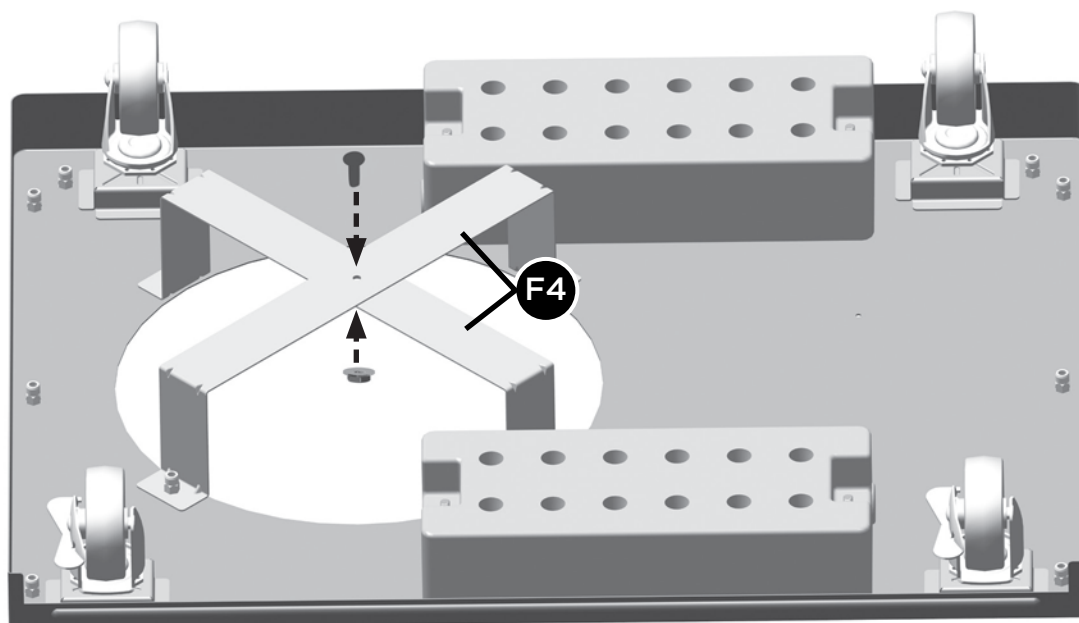
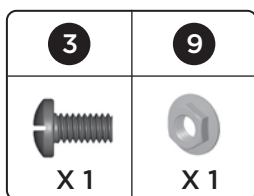

View from the back.

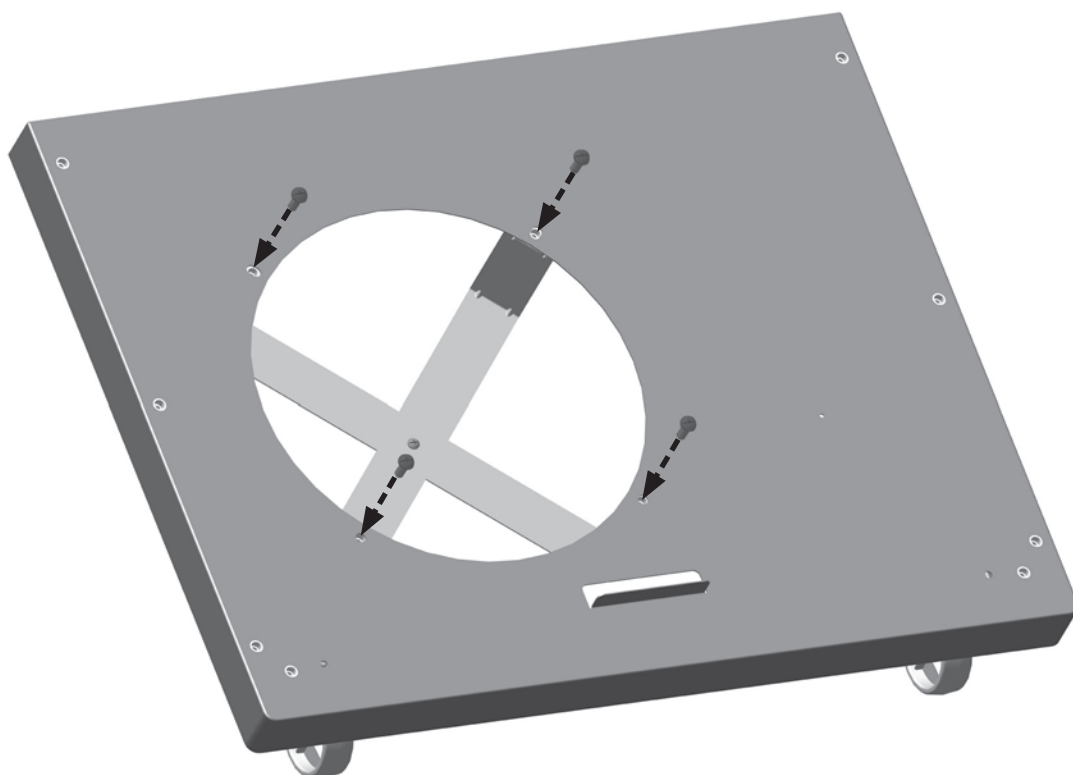
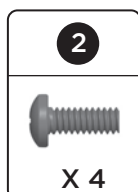

ASSEMBLY INSTRUCTIONS

3

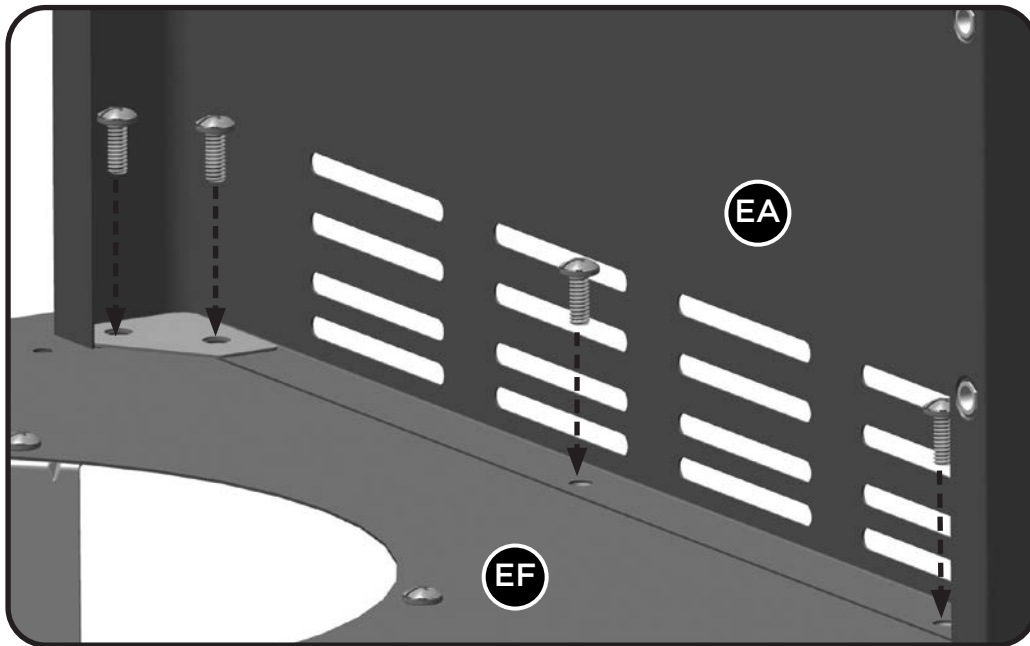

2



X 4

VIEW FROM THE BACK!

TIP:

Count all 4 screws as shown.

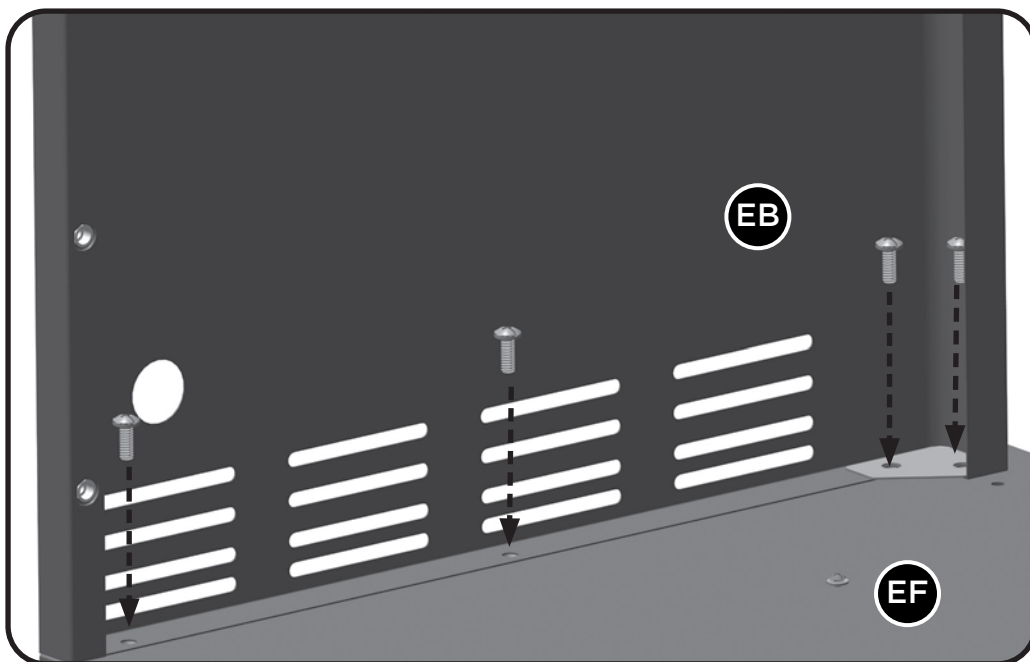

2



X 4

VIEW FROM THE BACK!

TIP:

Count all 4 screws as shown.

ASSEMBLY INSTRUCTIONS

4

TIP:

Ensure correct assembly position as shown below.

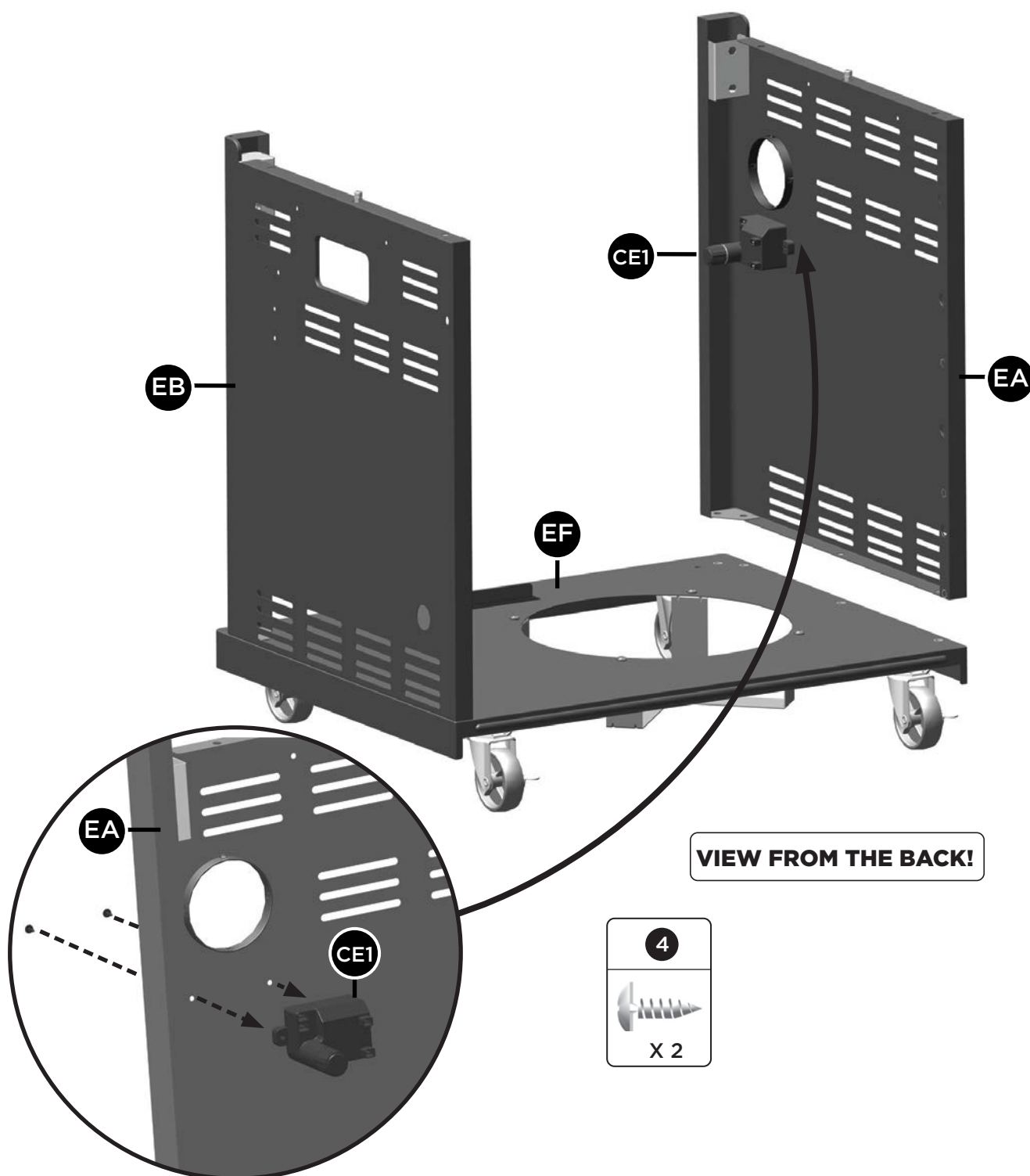

5

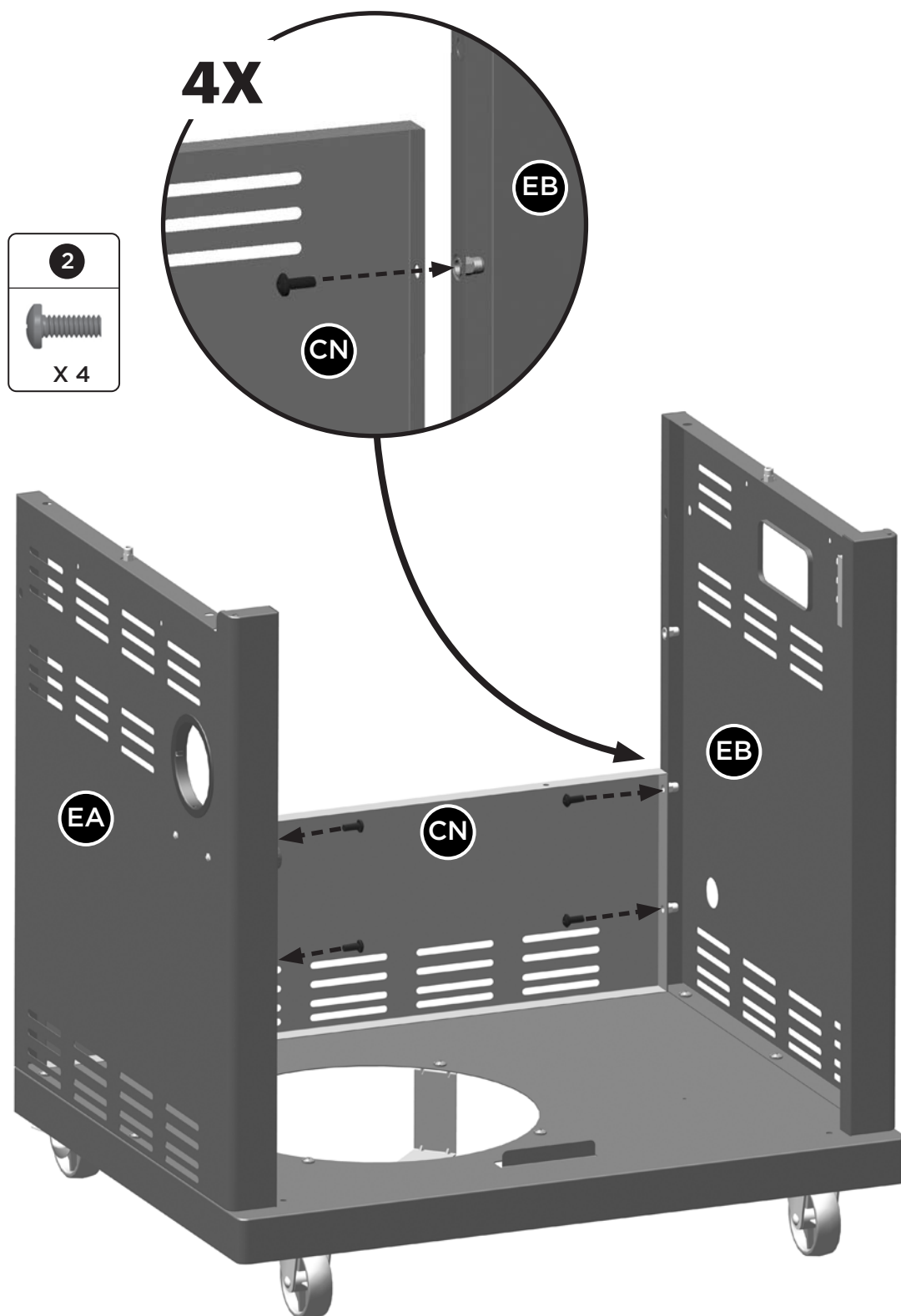

6

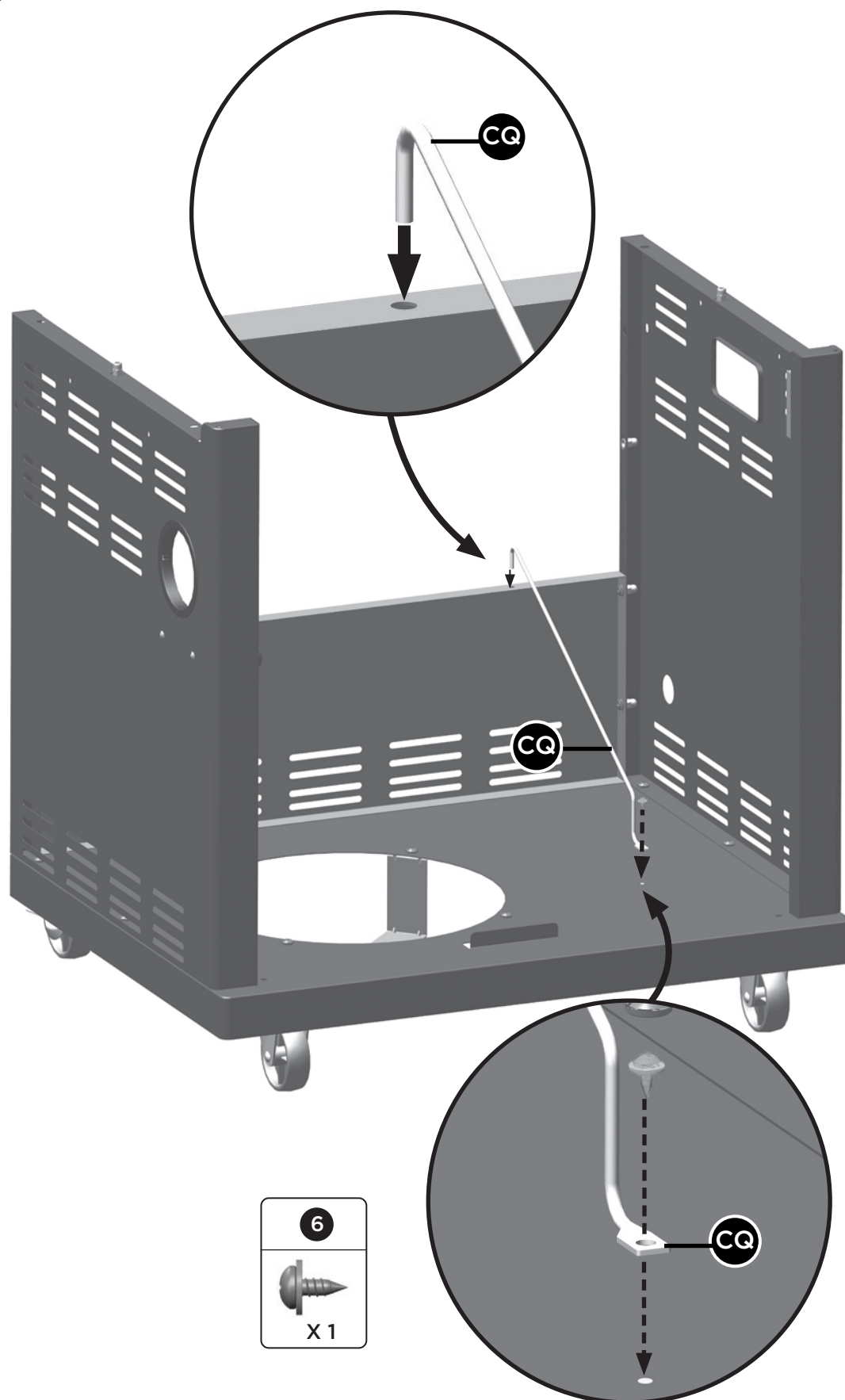

7

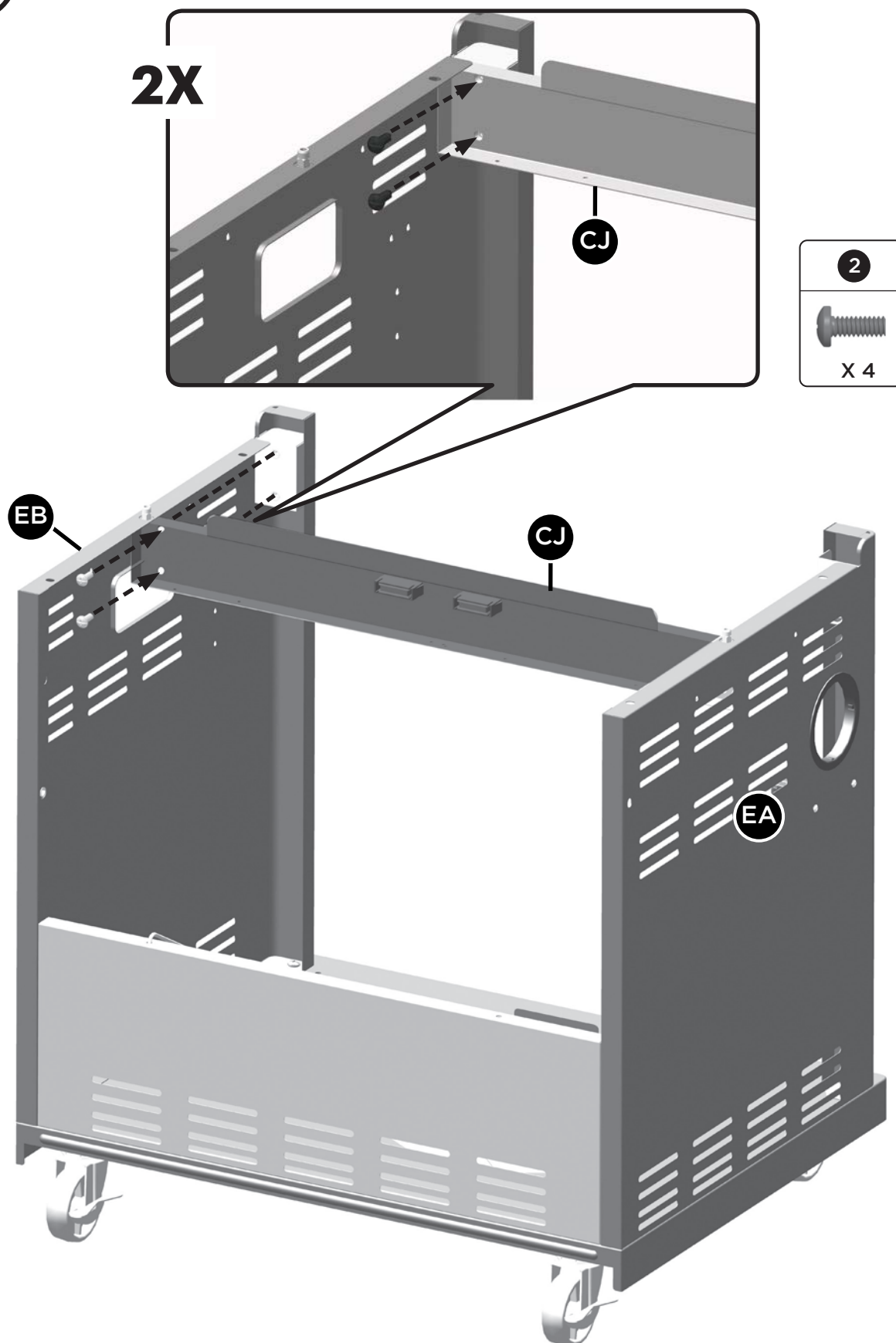

ASSEMBLY INSTRUCTIONS

8

A.

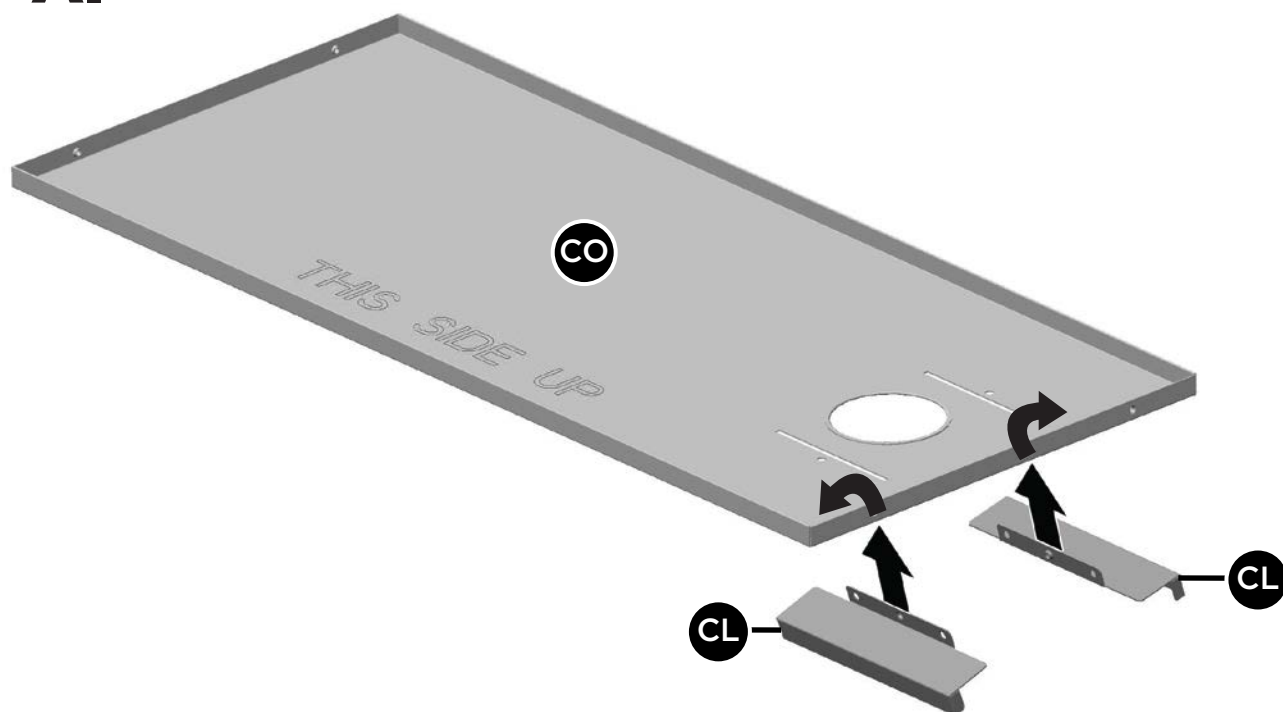

B.

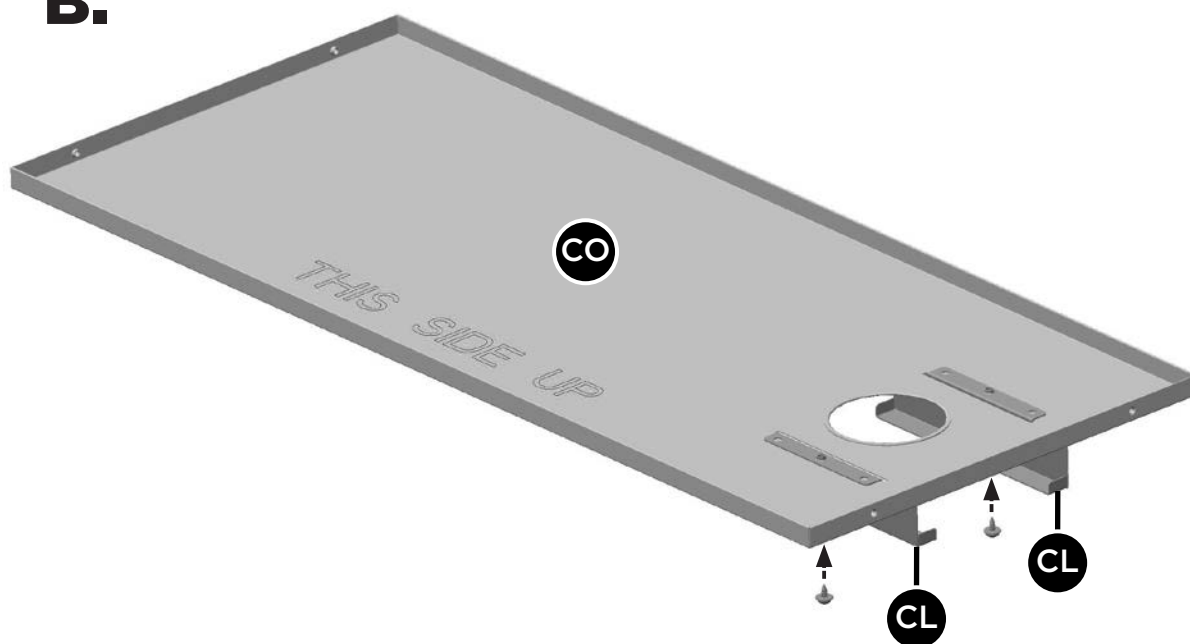

6



X 2

ASSEMBLY INSTRUCTIONS

9

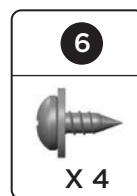
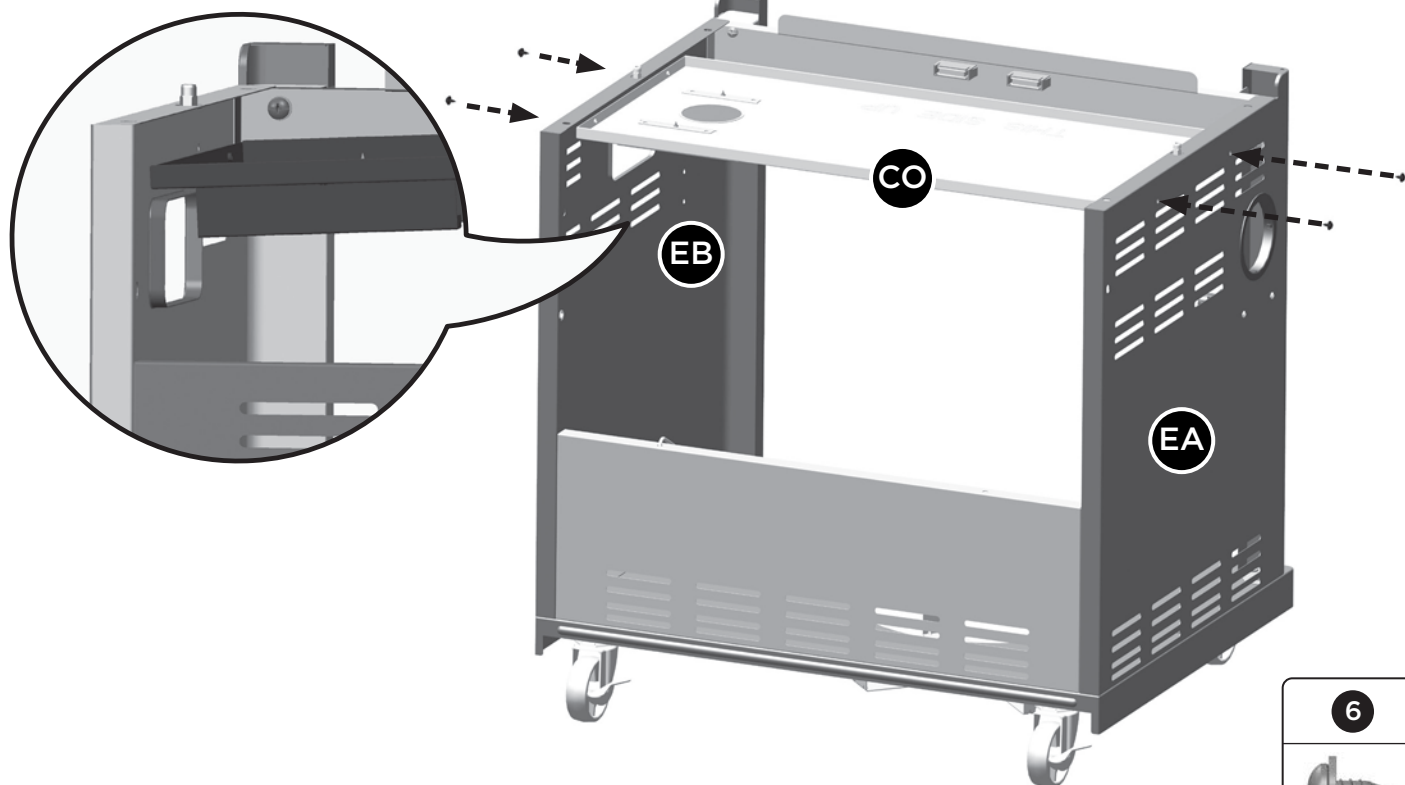

D.

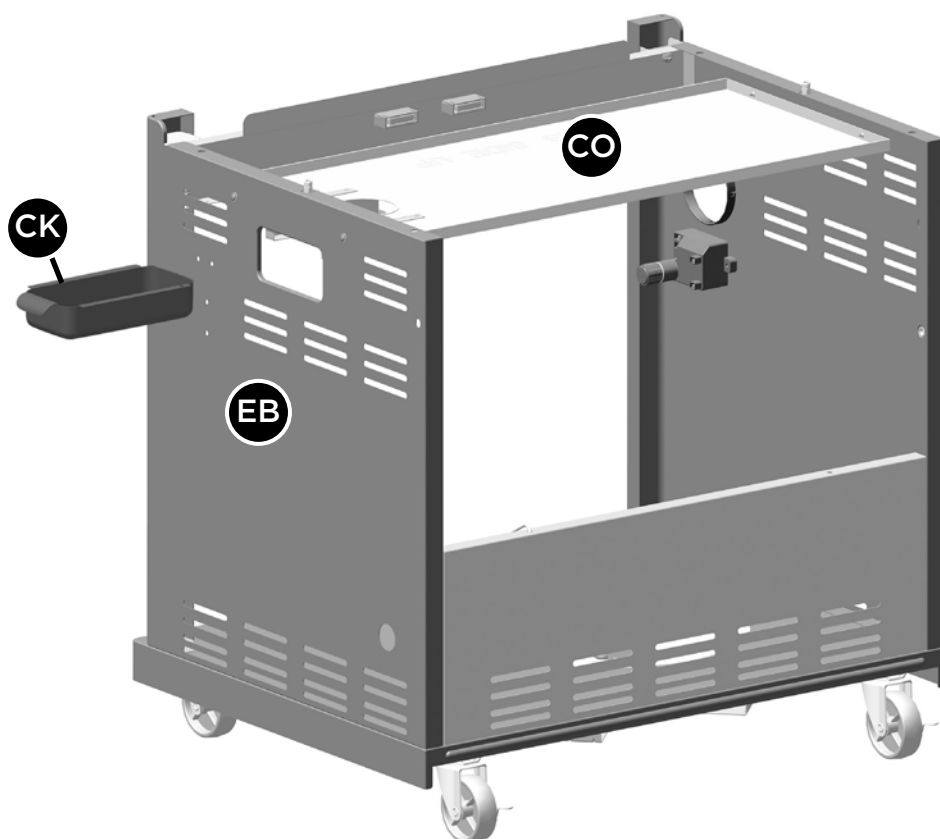

ASSEMBLY INSTRUCTIONS

10

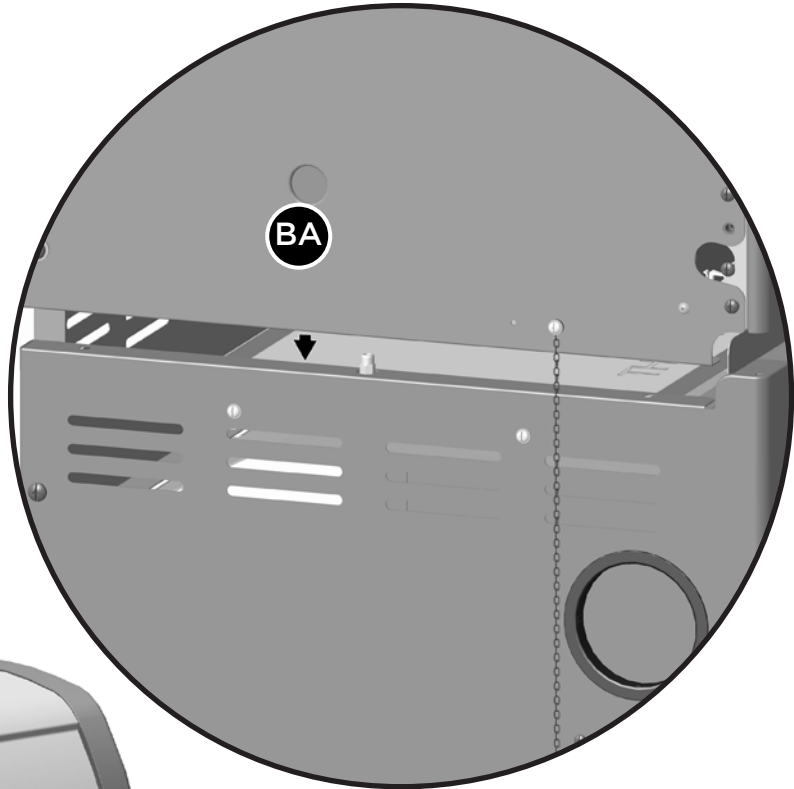
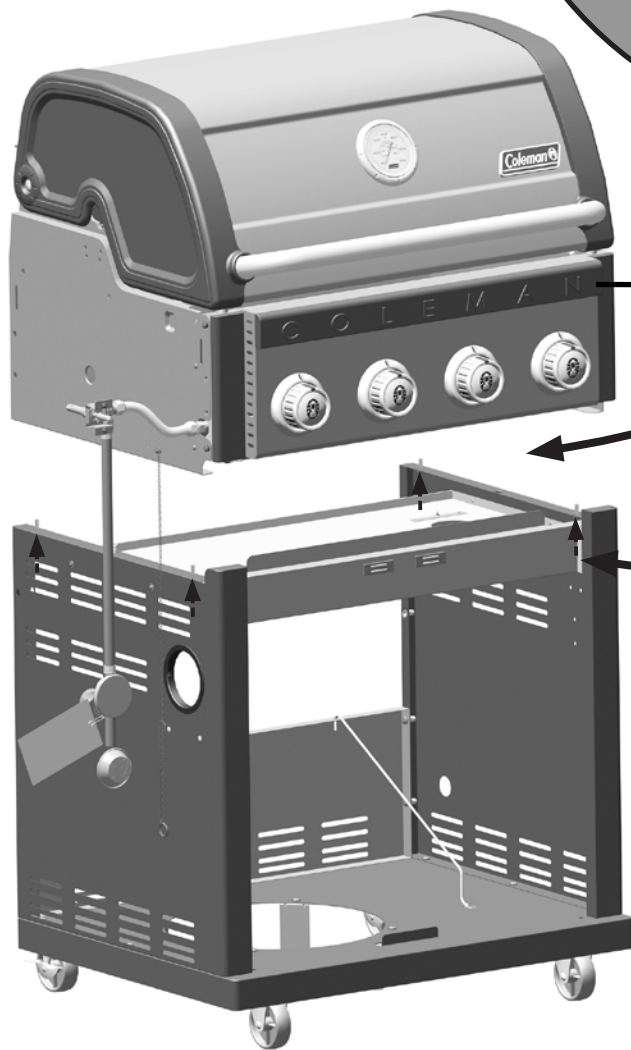

BA

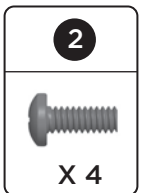

2X



BA

⚠ WARNING:
WATCH YOUR HANDS!

11

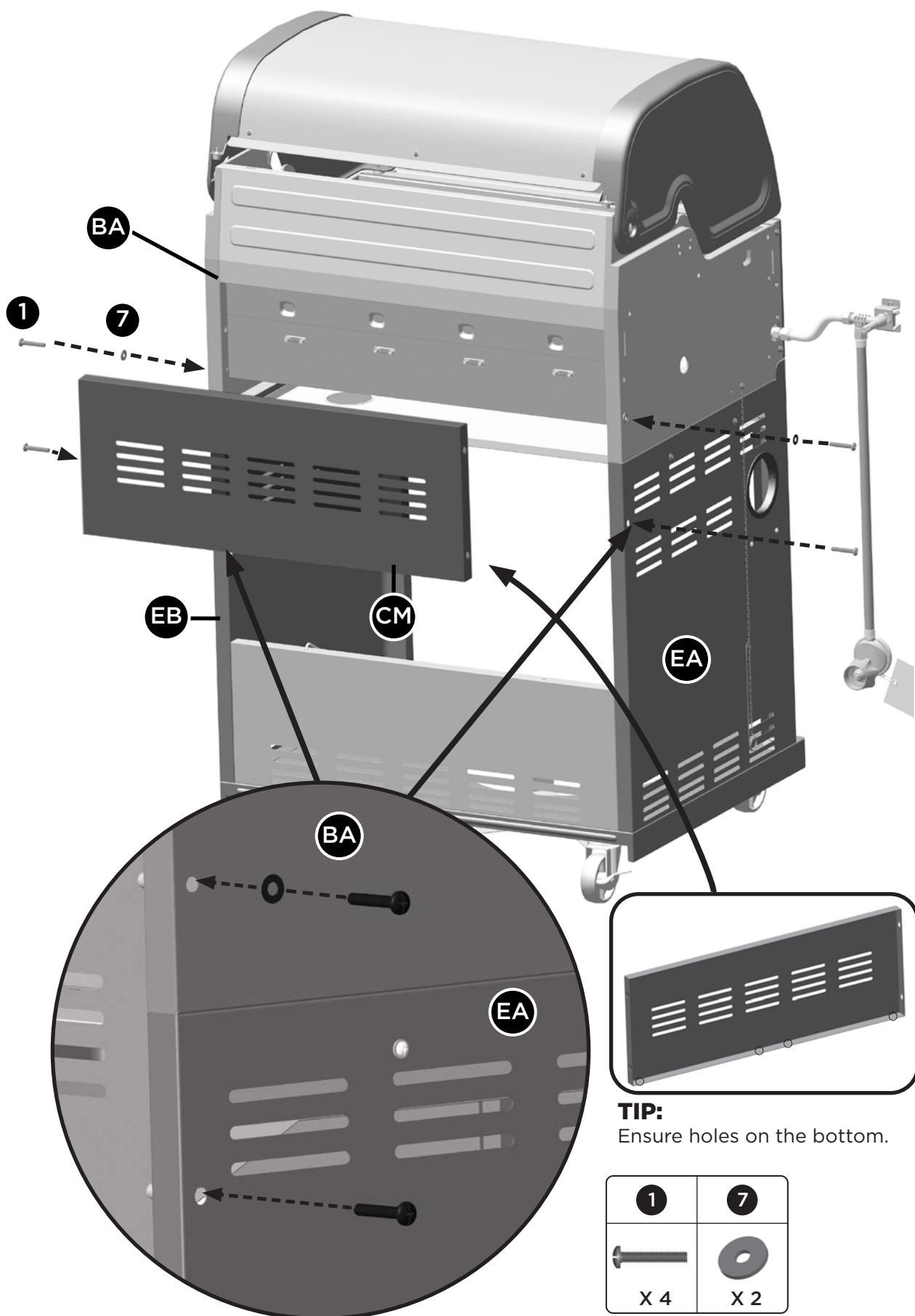

12

A.

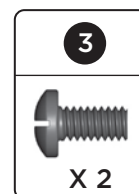
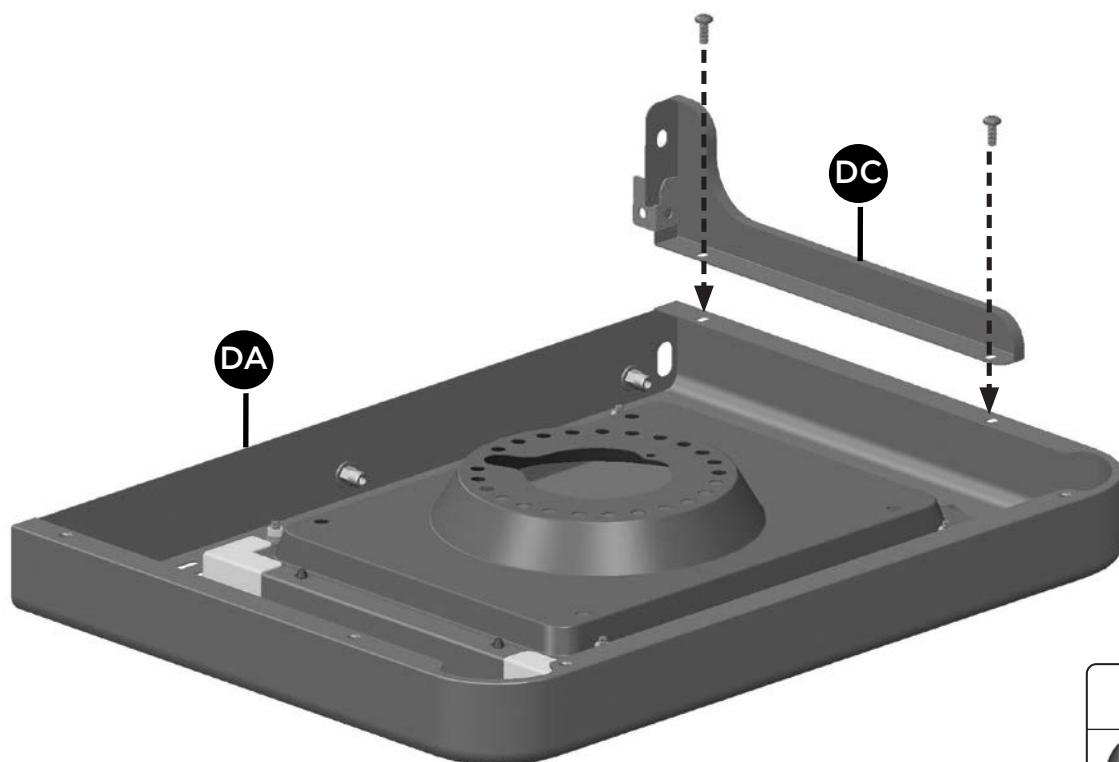

B.

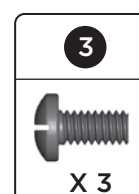
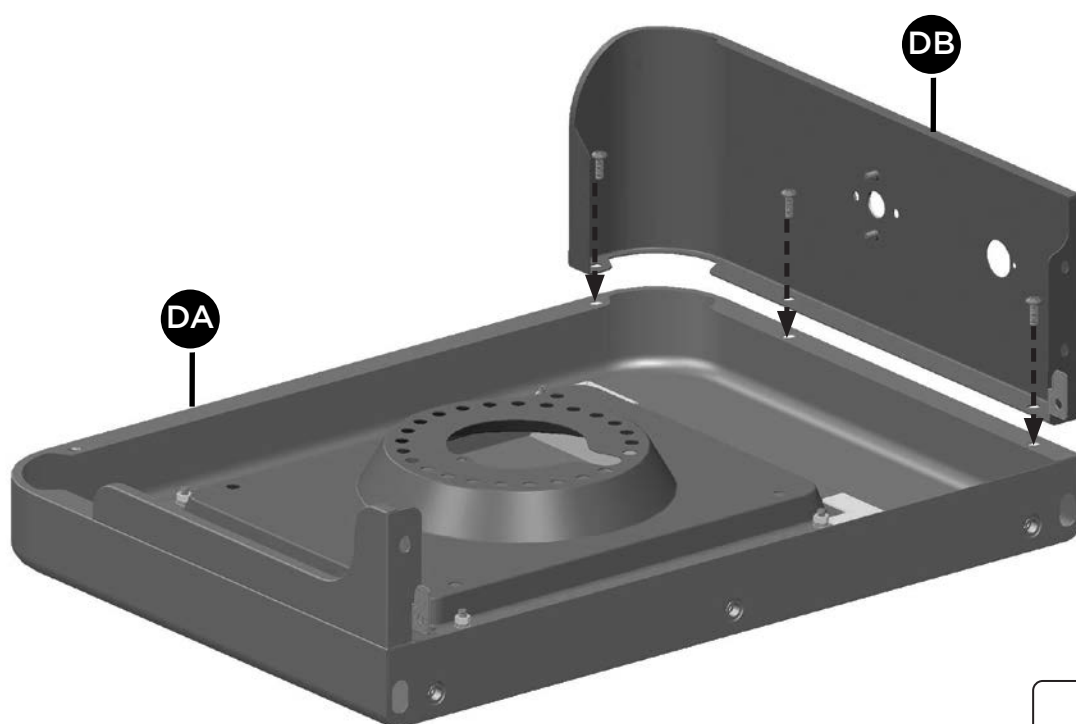

13

A.

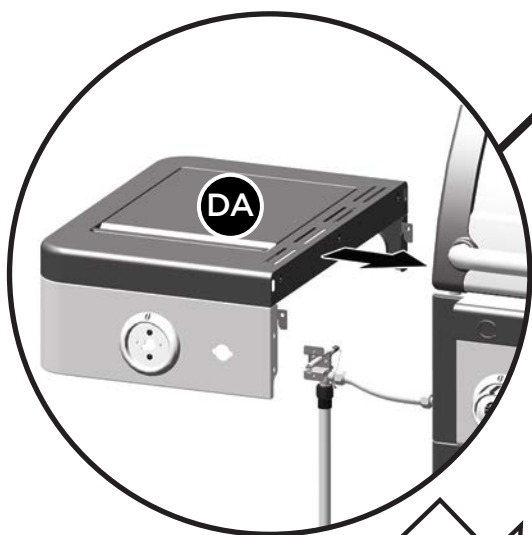
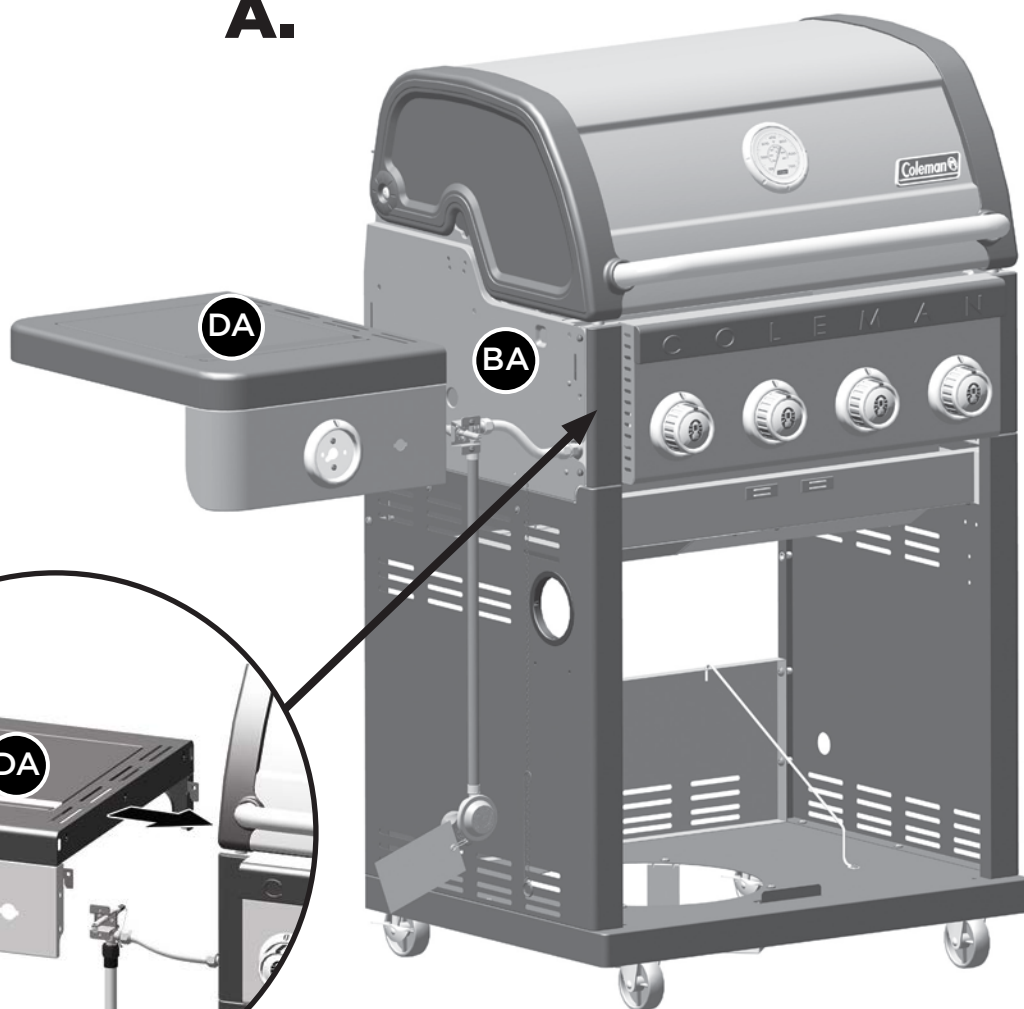

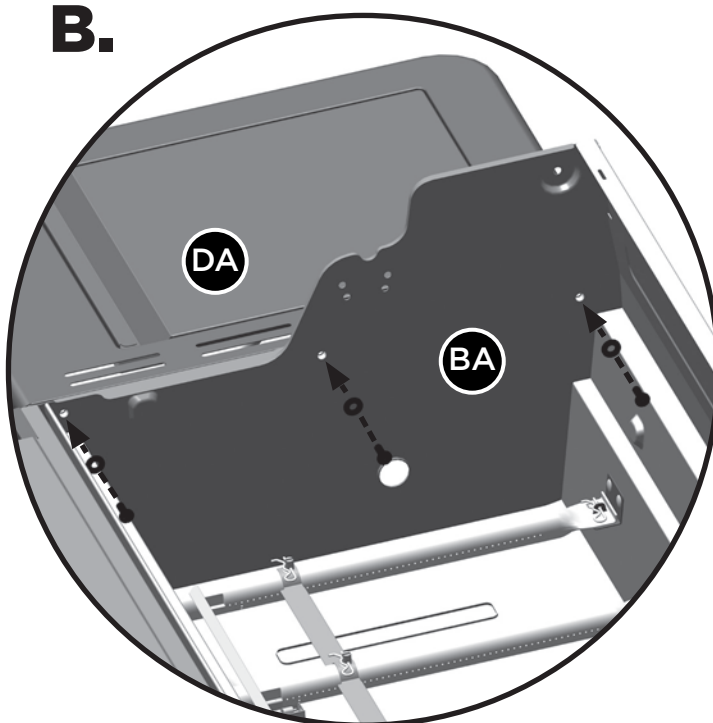

B.



TIP:

- 1.Ensure that the rubber side of the rubberized washer makes contact with the burner box.
- 2.Only tighten screw halfway.

2	7
	
X 3	X 3

14

C.

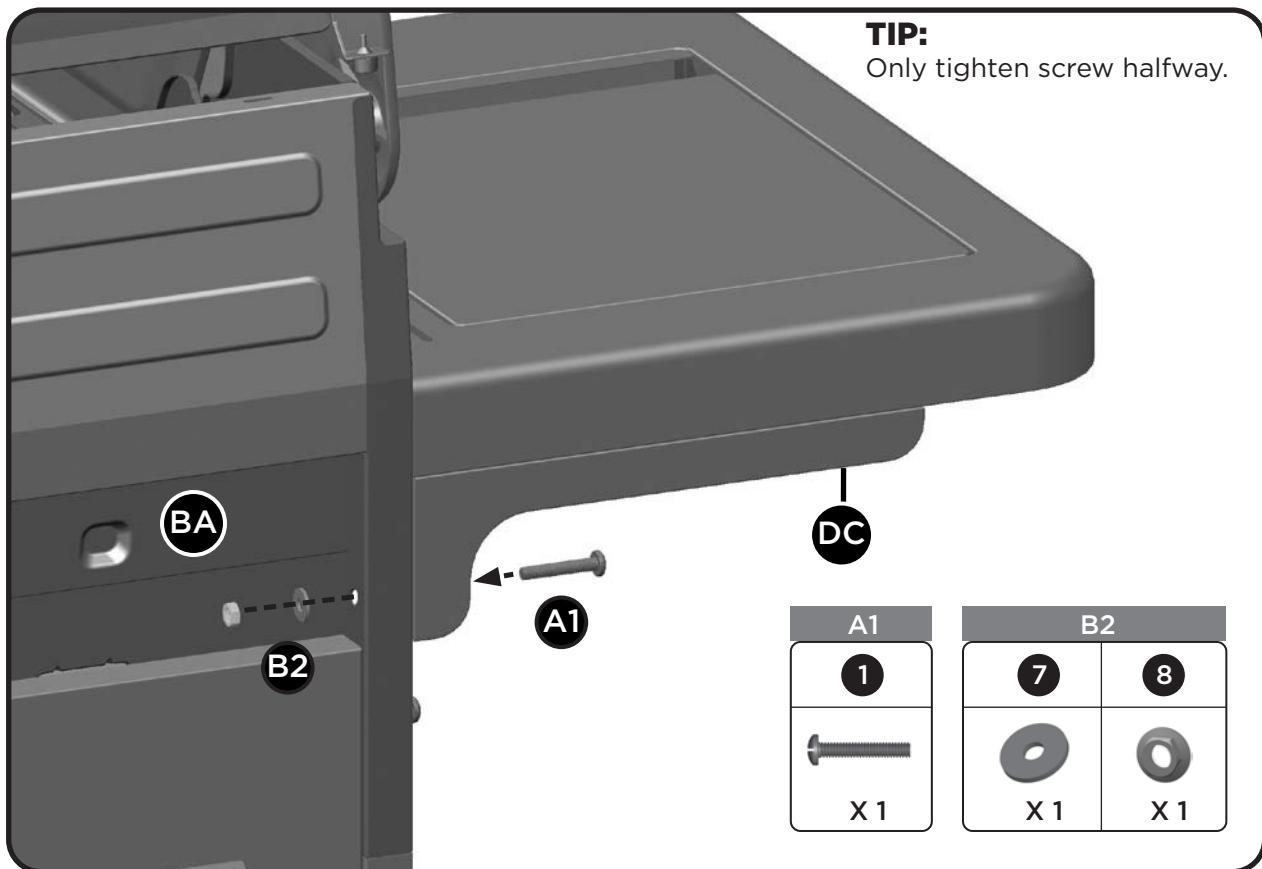

D.

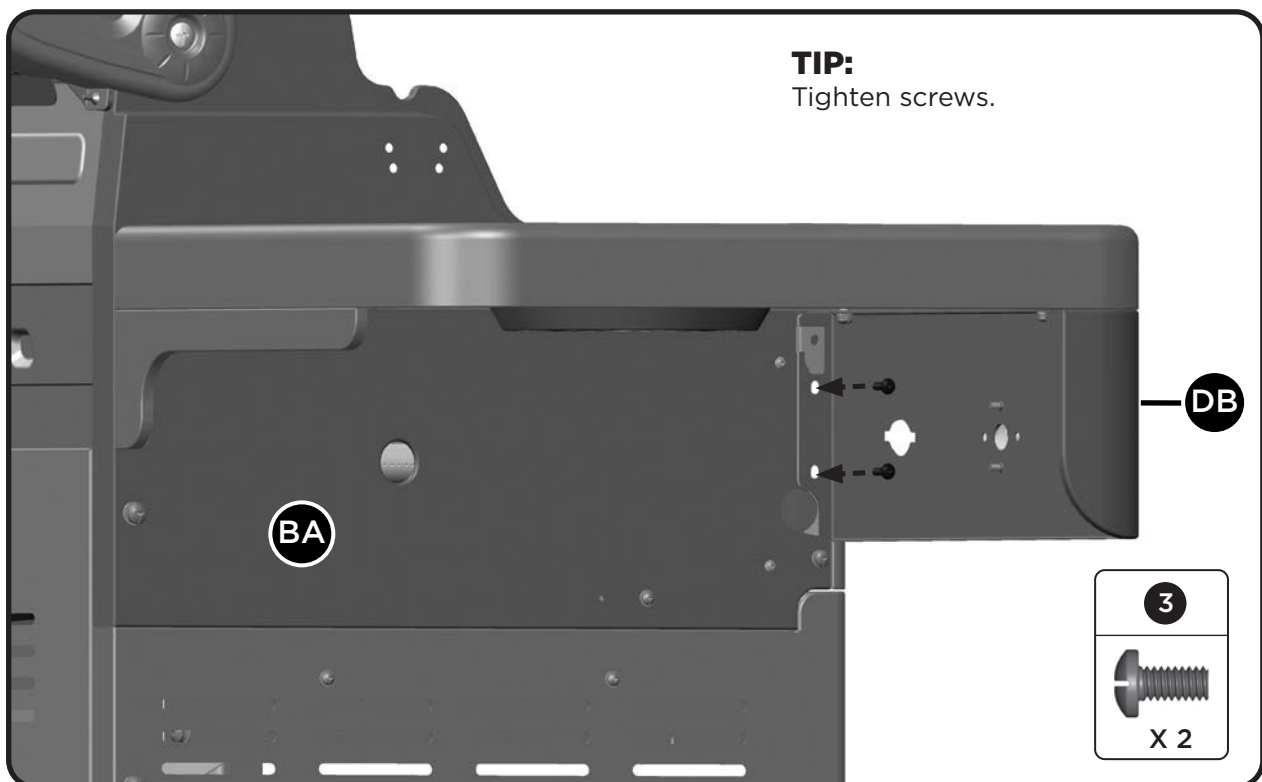

ASSEMBLY INSTRUCTIONS

15

TIP:

Tighten screws.

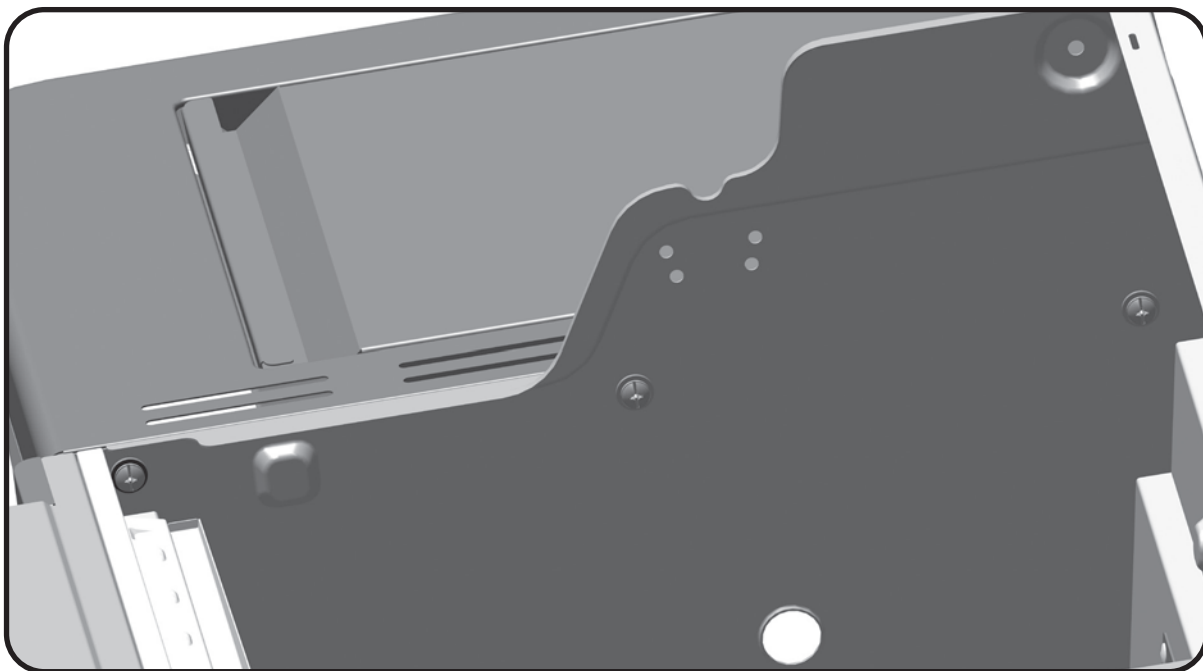

TIP:

Tighten screws.



16

E.

Front view

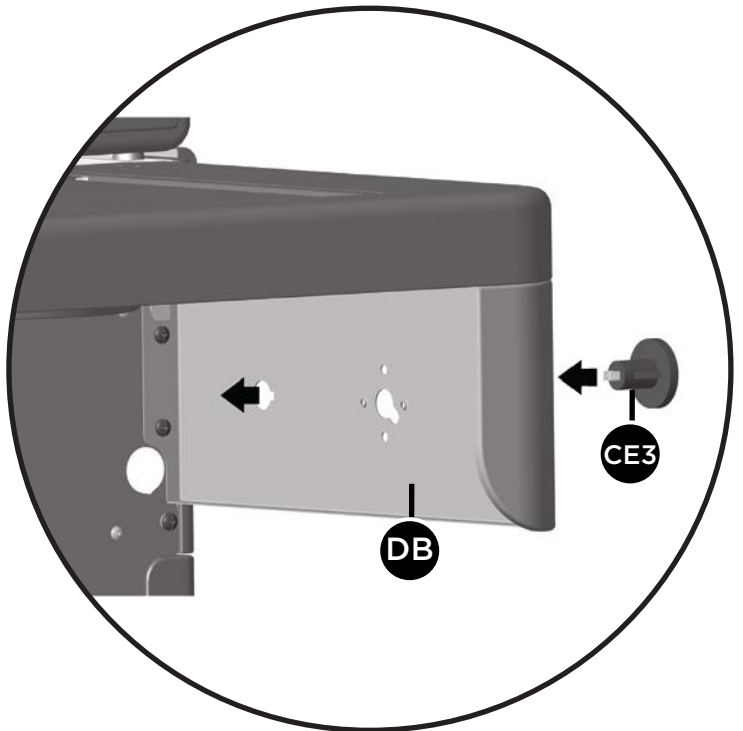
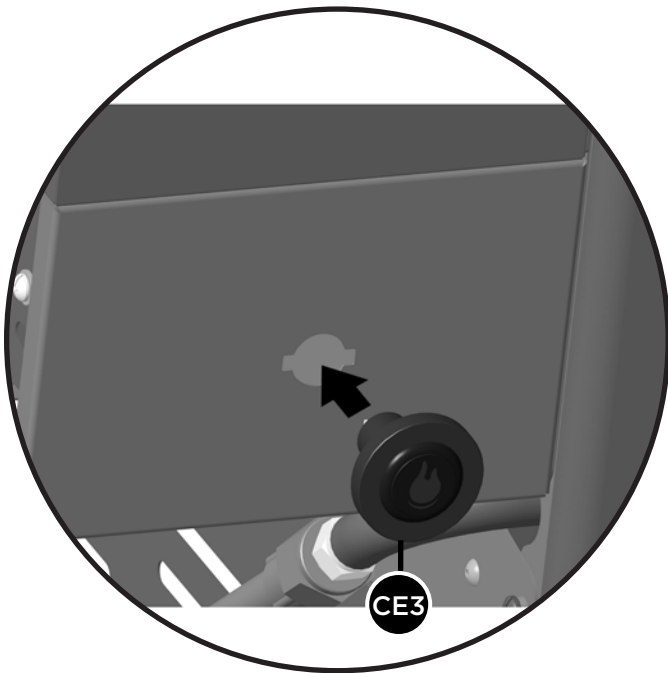

TIP:

Ensure wire are fully connected.

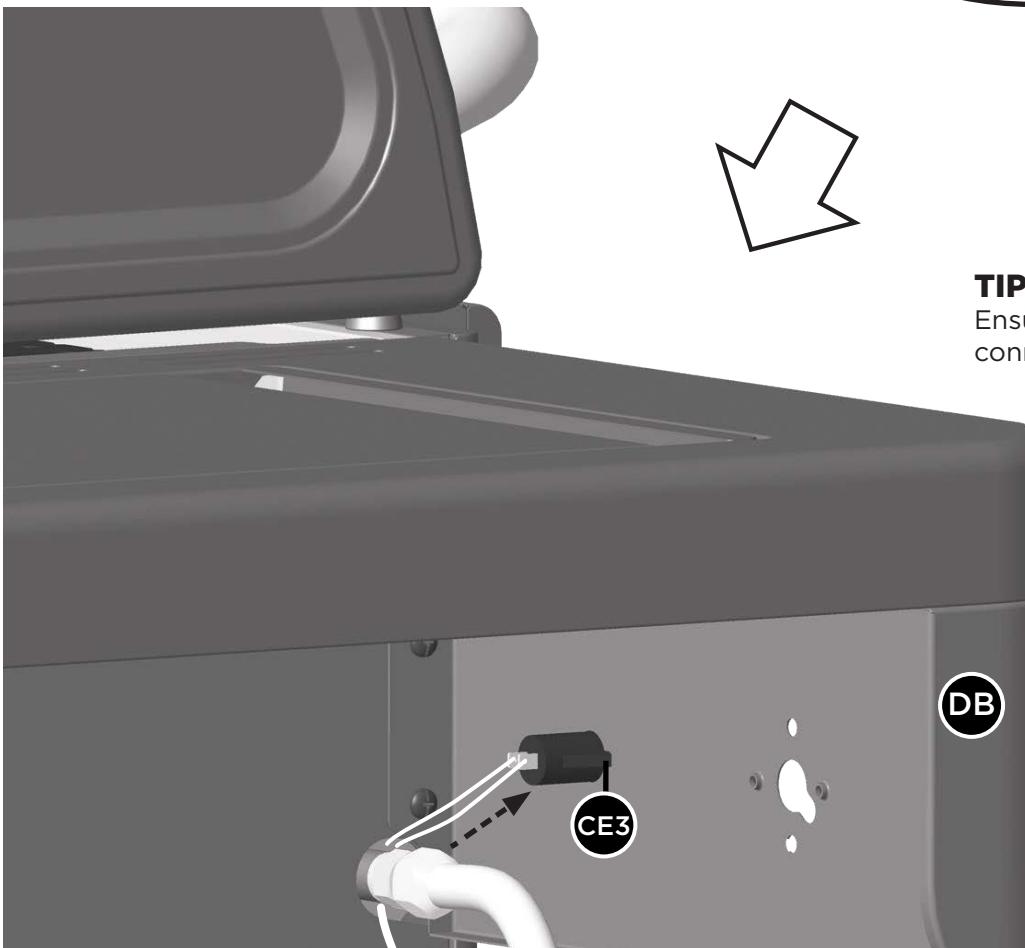

17



18

D.

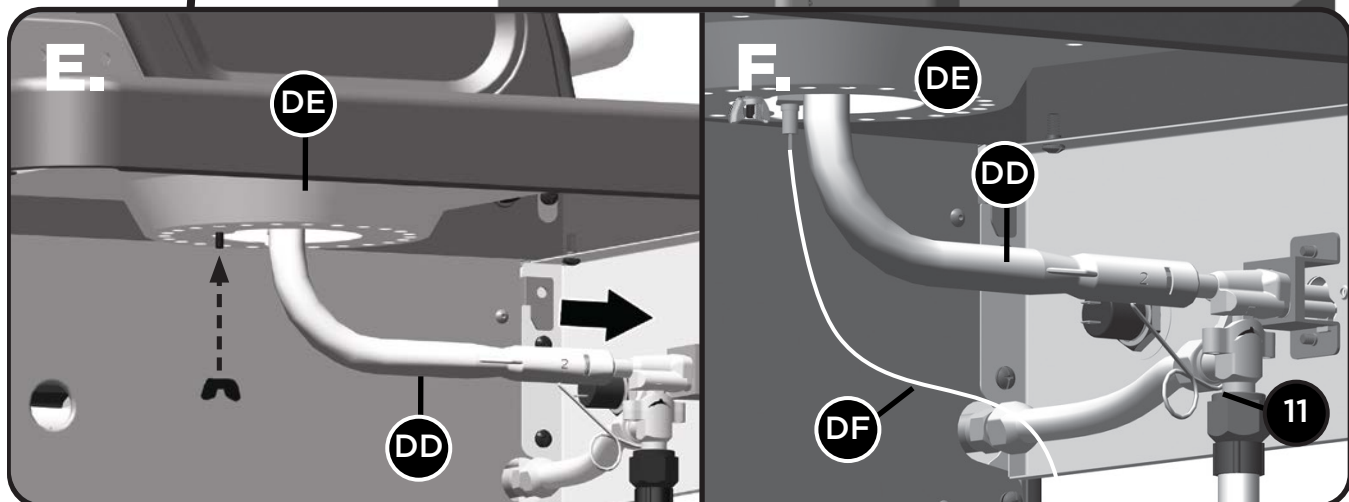
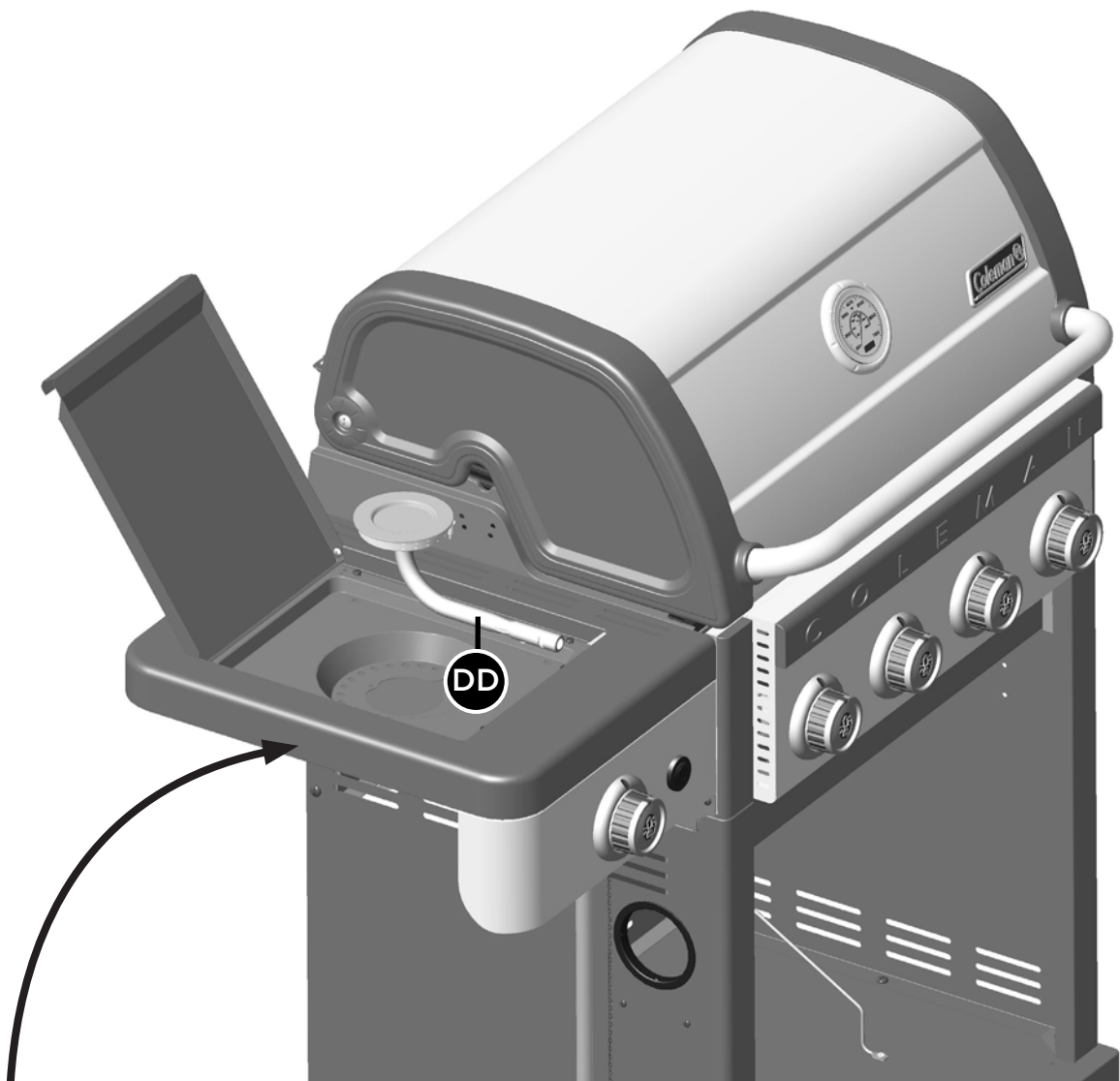

10



X 1

11



X 1

19

H.



20

Electronic Ignition Assembly:

The electrode set for main burner (CF), side stove (DF) and InstaStart button (CE3) are found under the control panel (CI) attached to the manifold (CA). Insert the electrode sets into the electronic ignition (CE1)

(CE3)
InstaStart
Button

CE1

CE2

DF

CF

CE3

CE2

CE1

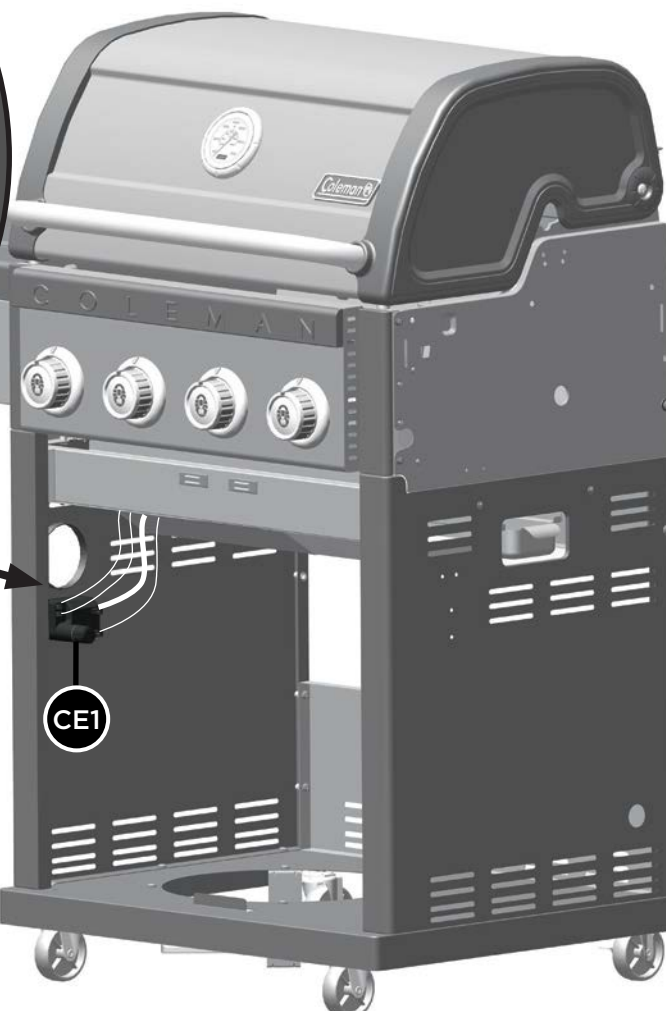

ASSEMBLY INSTRUCTIONS

21

6



X 4

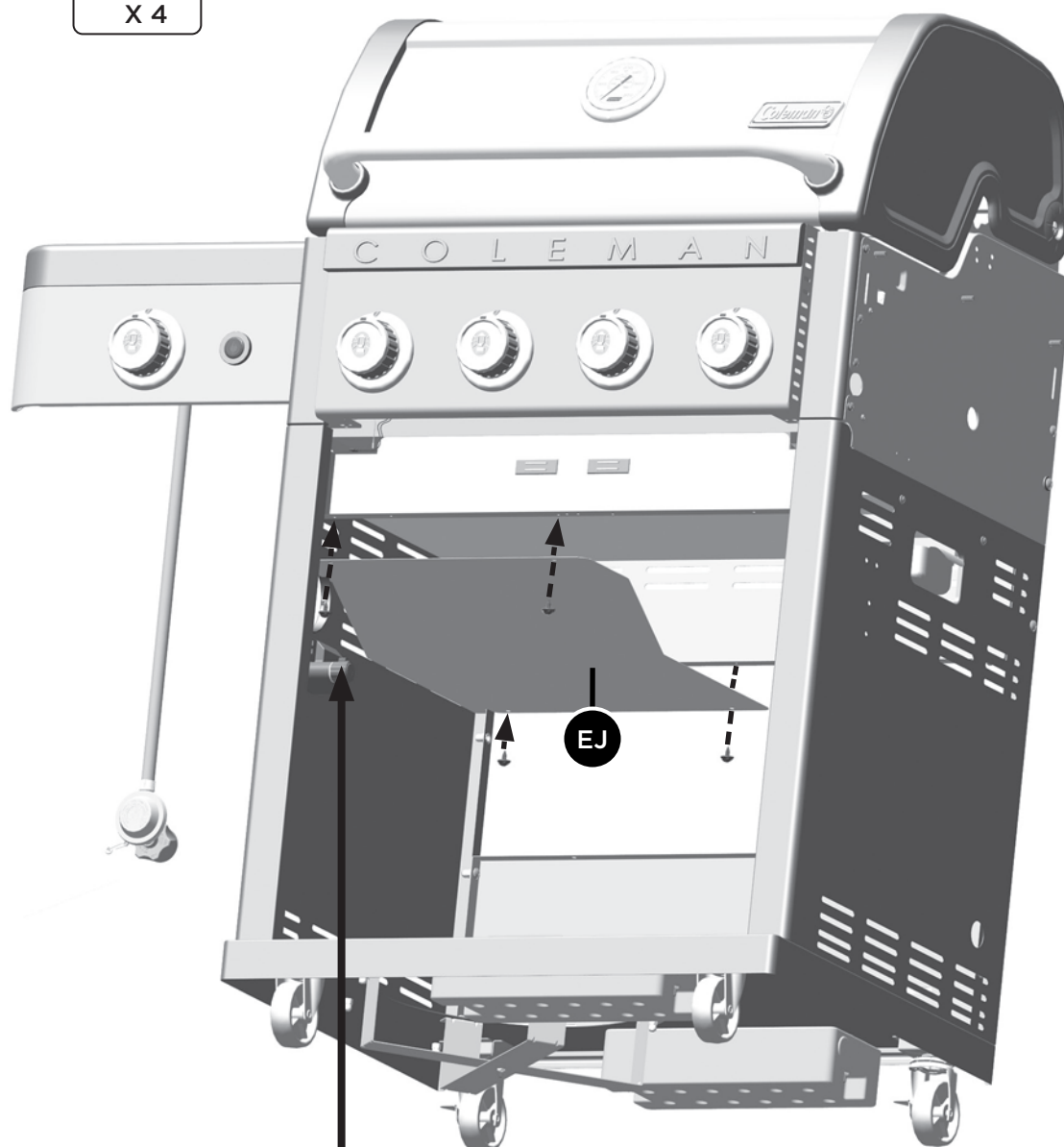

EJ

GAP

EJ

TIP:

Ensure that all wires pass through the Left Heat Shield gap.

ASSEMBLY INSTRUCTIONS

22

6



X 4

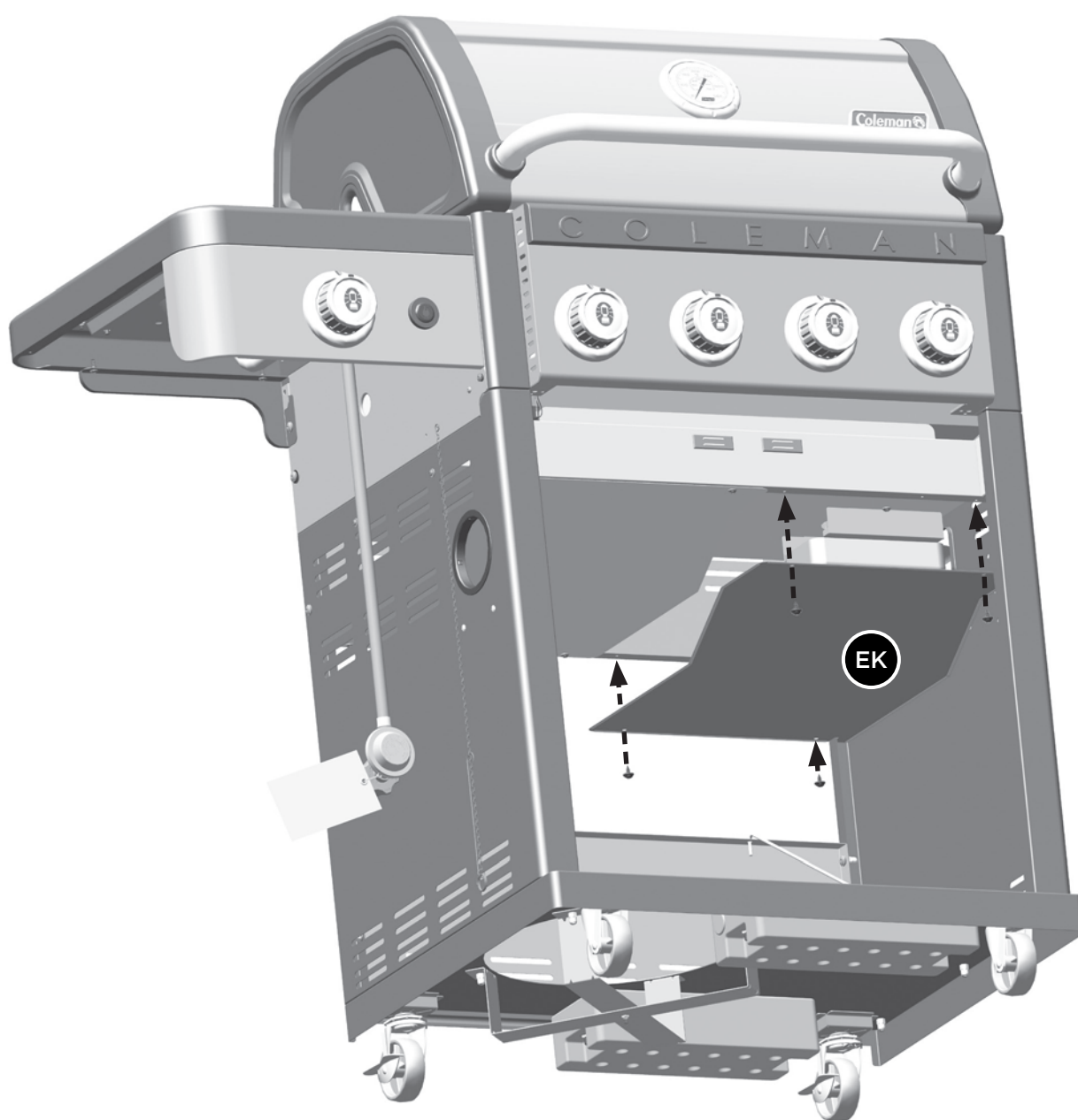

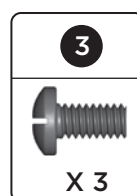
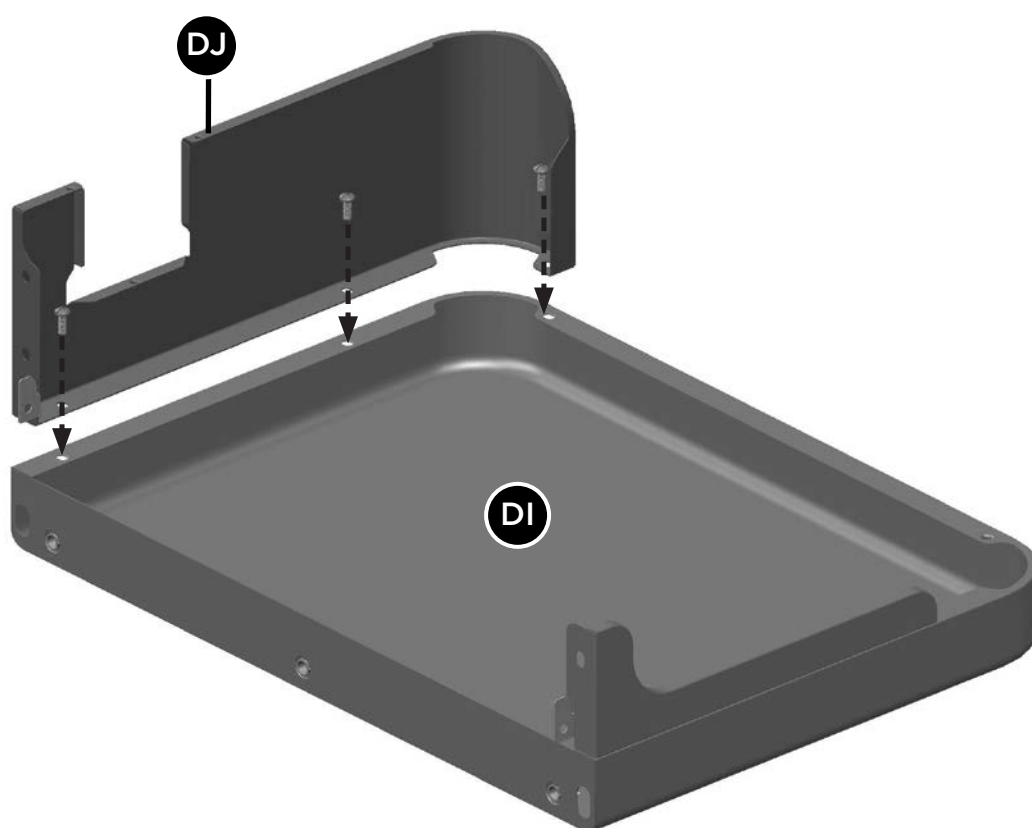
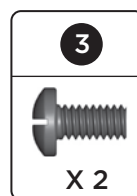
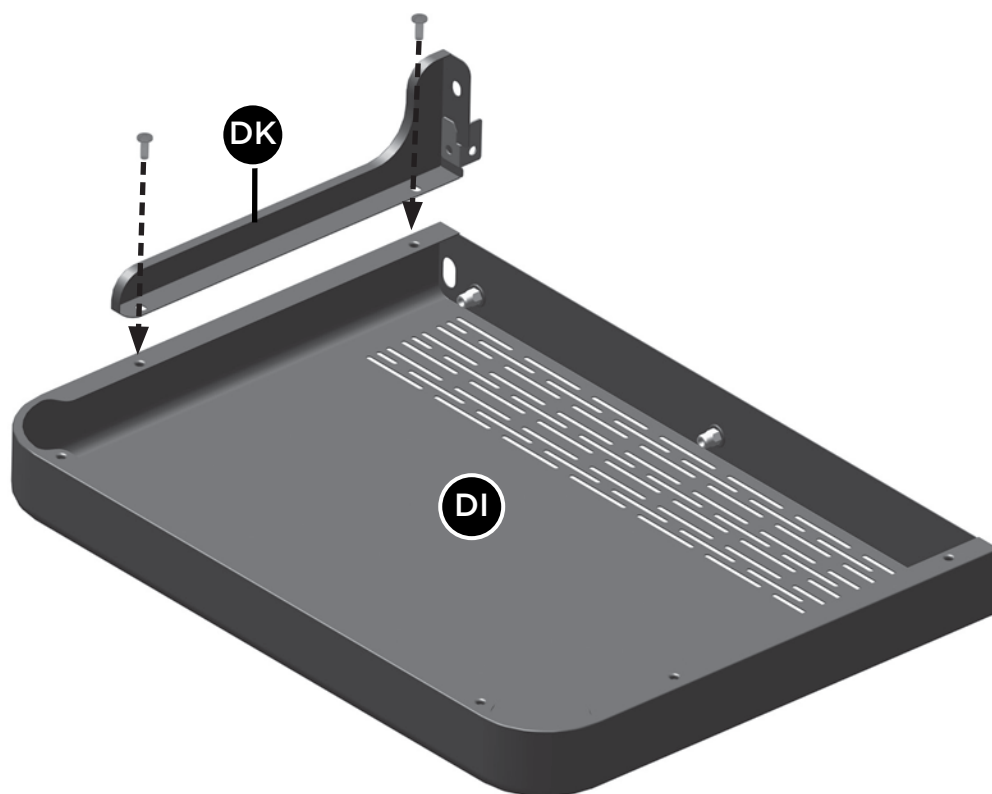

23



ASSEMBLY INSTRUCTIONS

24

TIP:
Only tighten screw halfway.

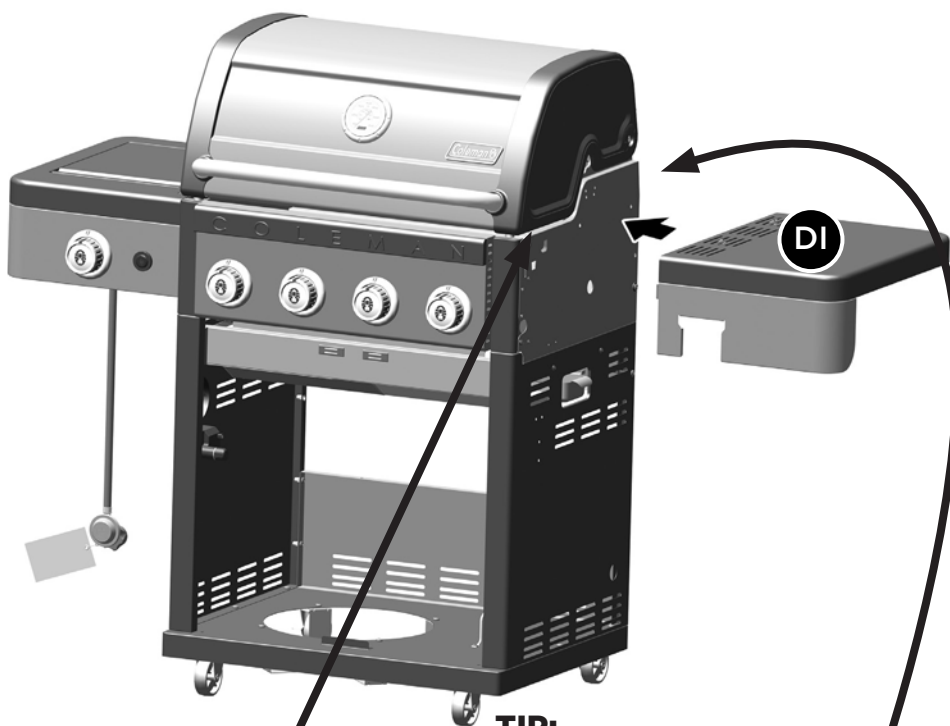

2	7
	
X 3	X 3

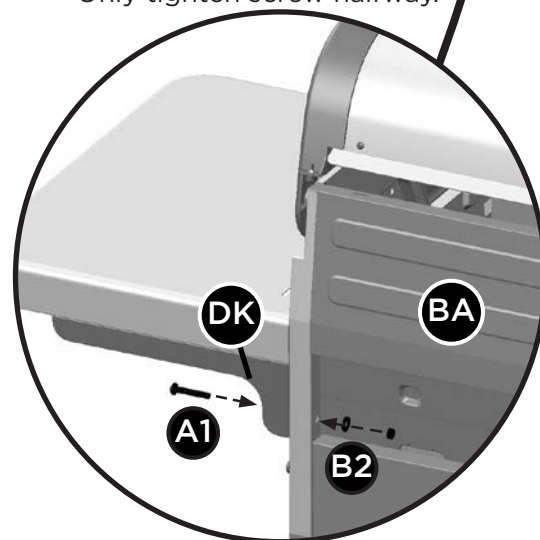
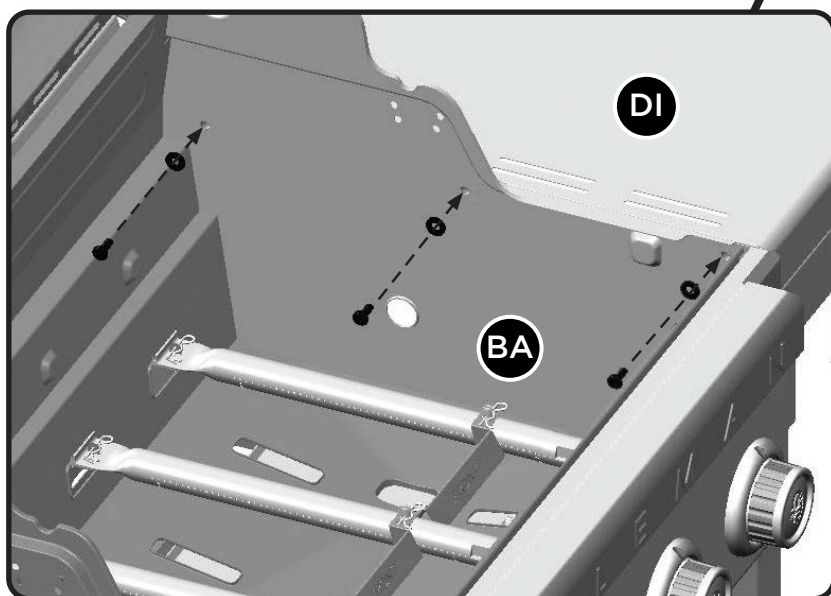

TIP:
Only tighten screw halfway.



A1
1

X 1

B2	
7	8
	
X 1	X 1

TIP:
Tighten screws.

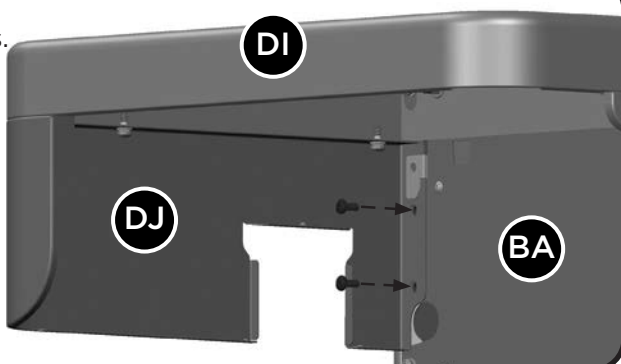
3

X 2



ASSEMBLY INSTRUCTIONS

25

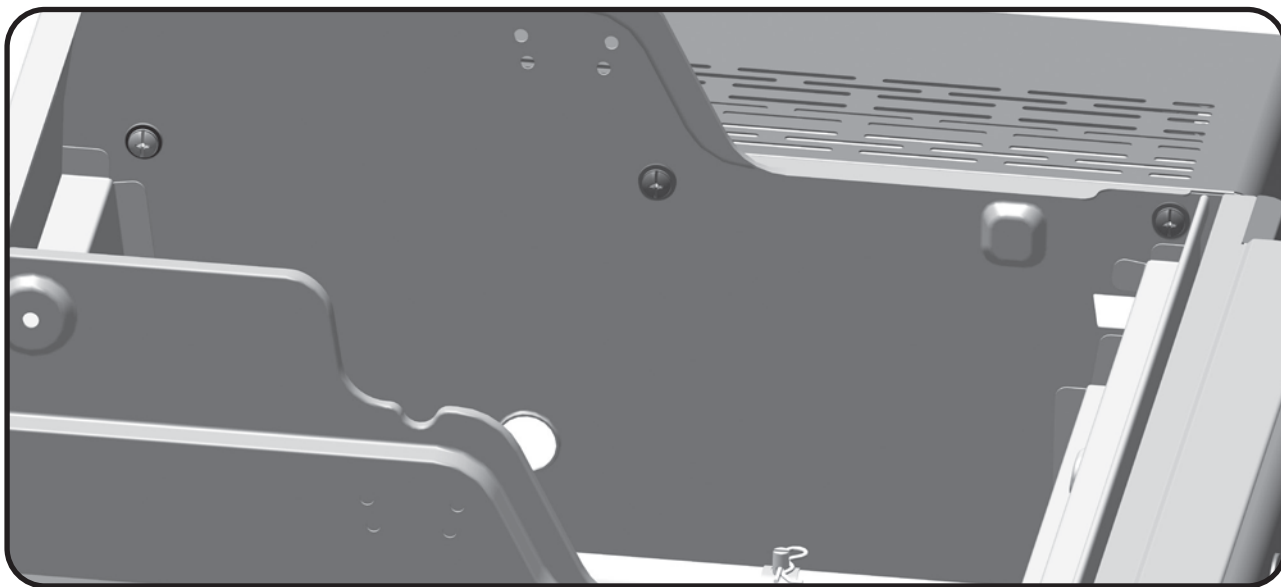
TIP:
Tighten screws.



TIP:
Tighten screws.

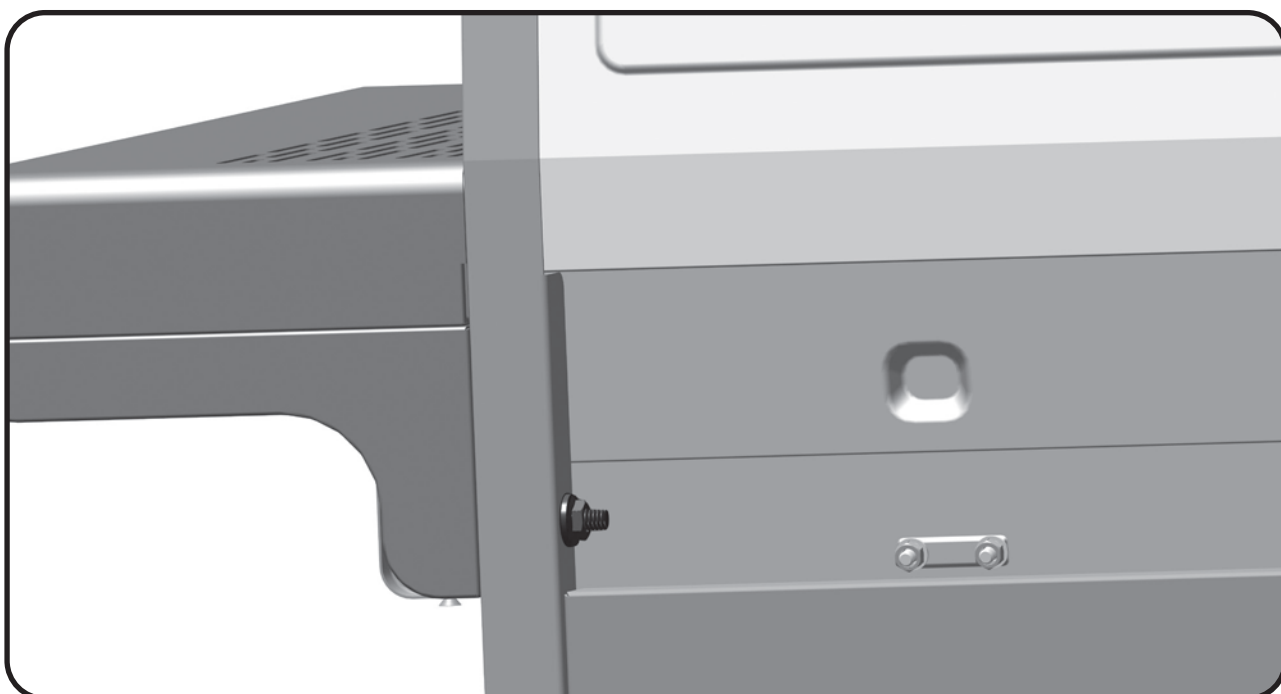

ASSEMBLY INSTRUCTIONS

26

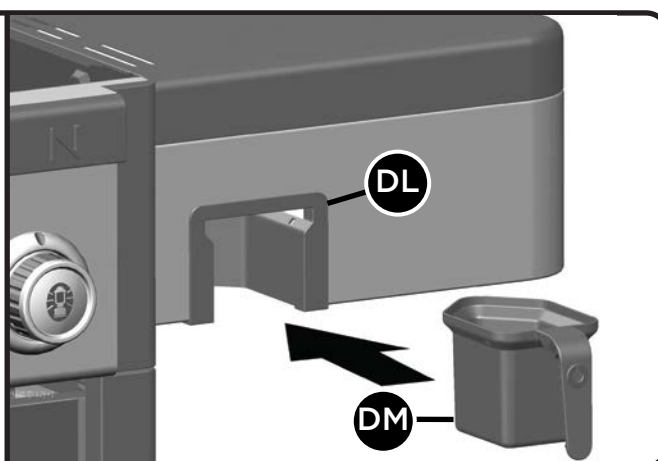
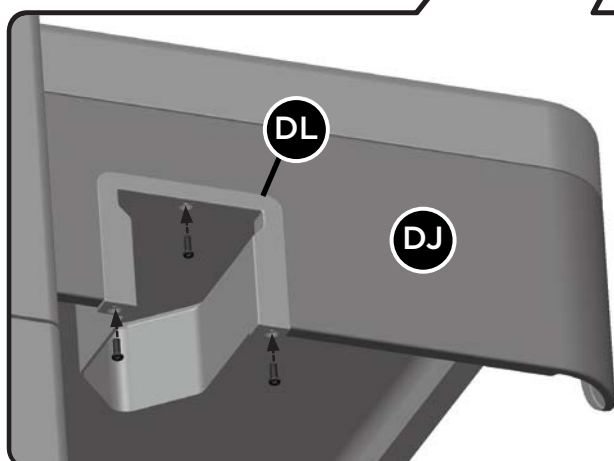

5



X 3

TIP:

Start with the middle screw.



ATTENTION:
EMPTY GREASE CUP AFTER
EACH USE.

ASSEMBLY INSTRUCTIONS

27

TIP:

Remove the Ignition Battery Cover and then install the Ignition Box.

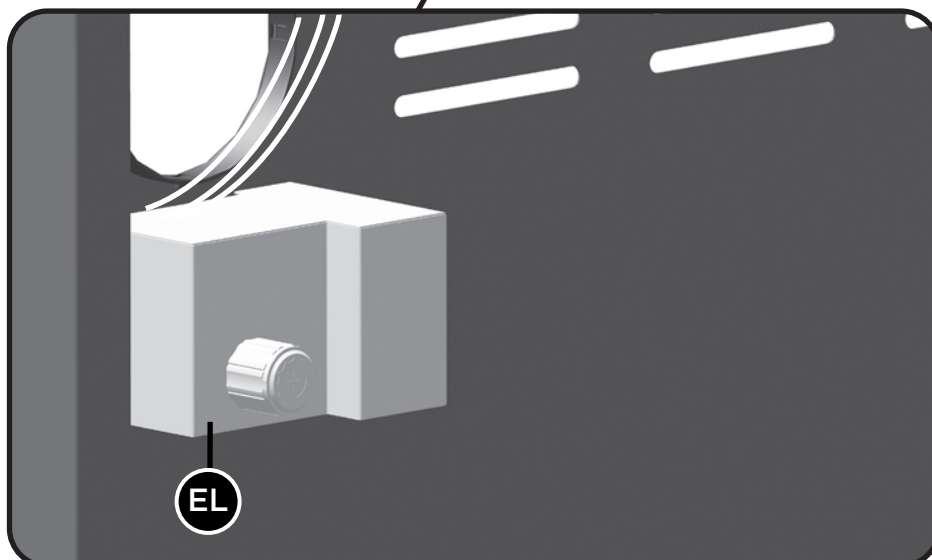

TIP:

All wires go through the gap.

28

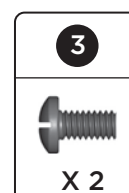
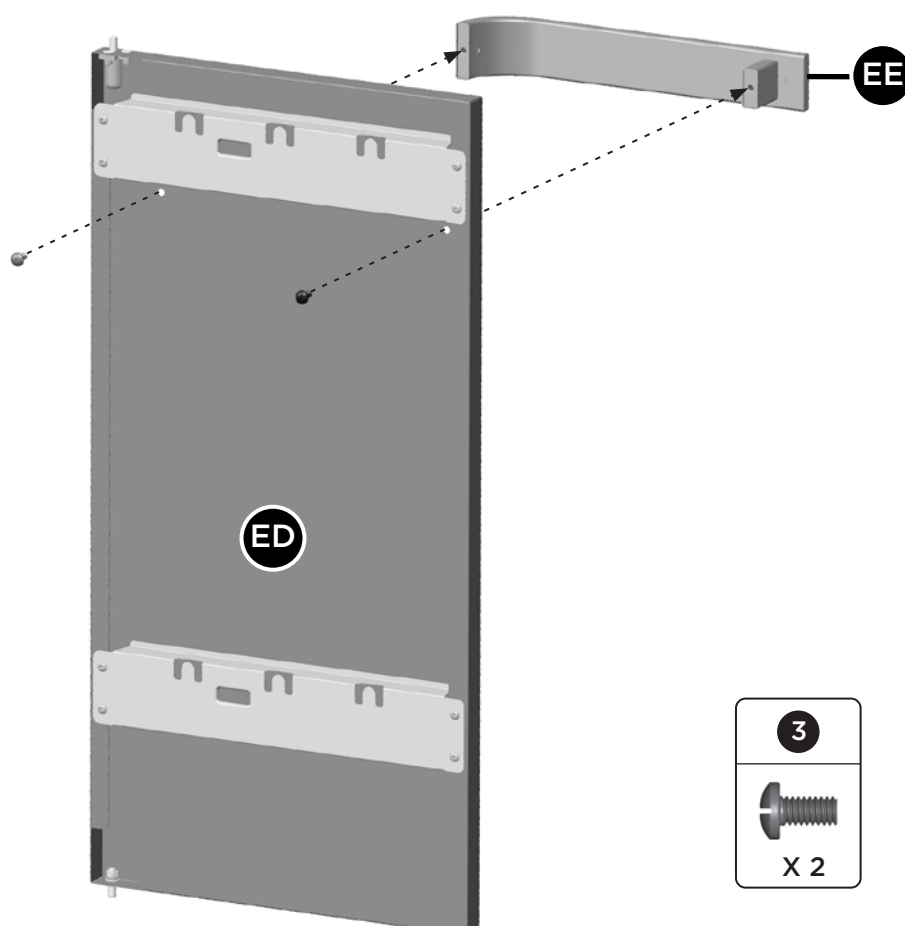
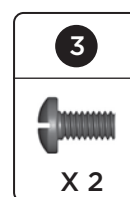
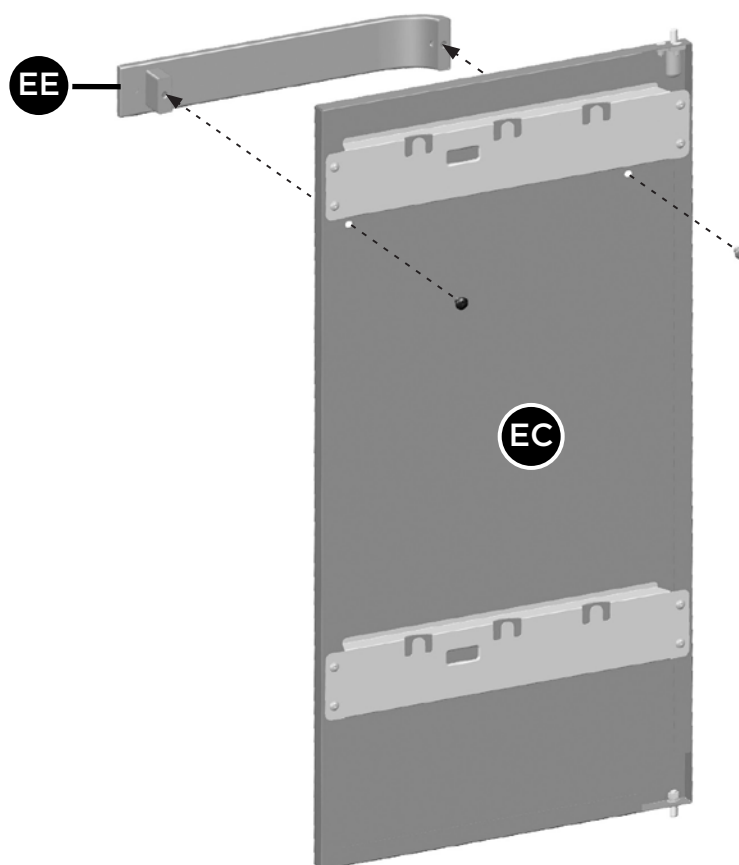

29

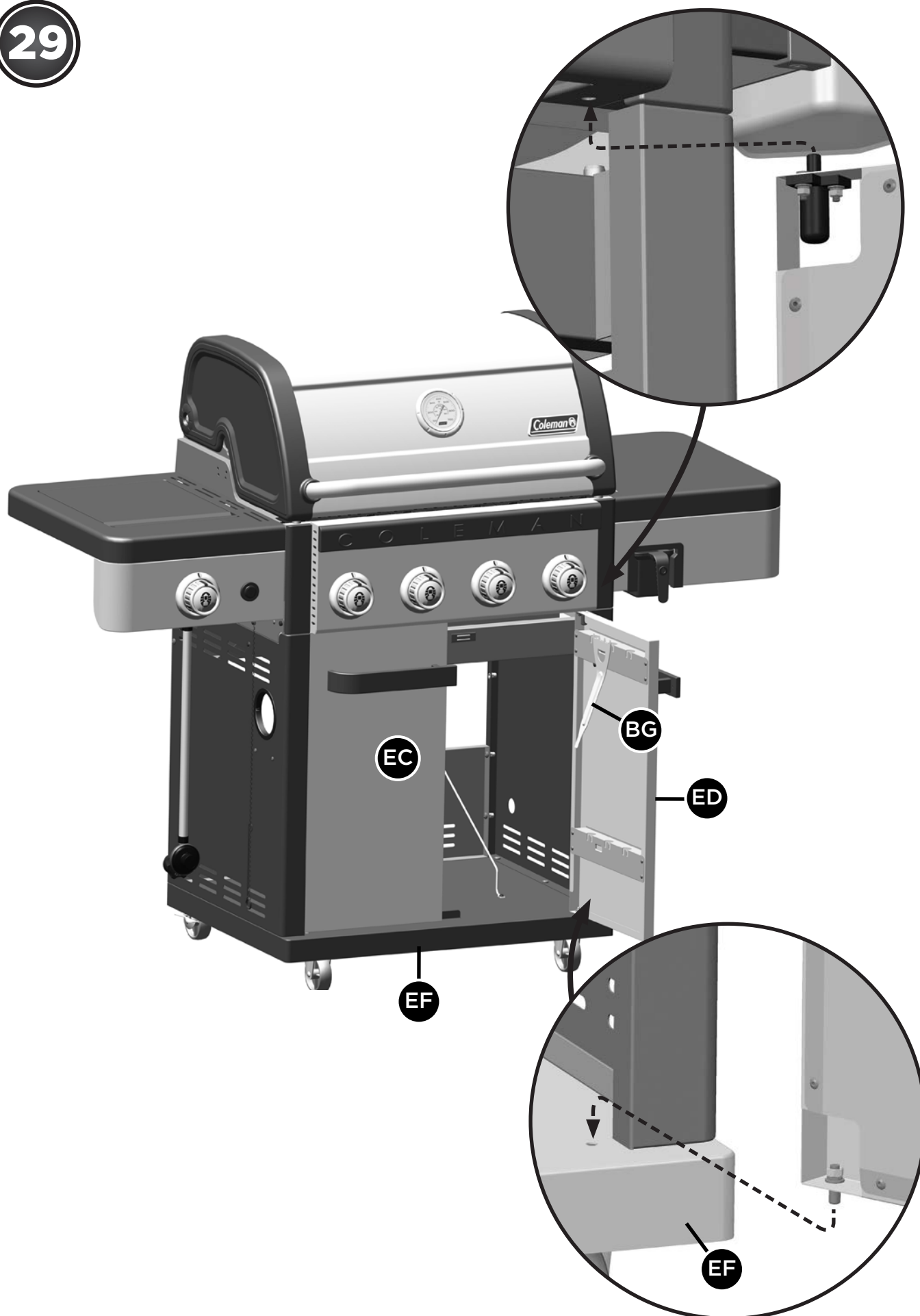

30



31

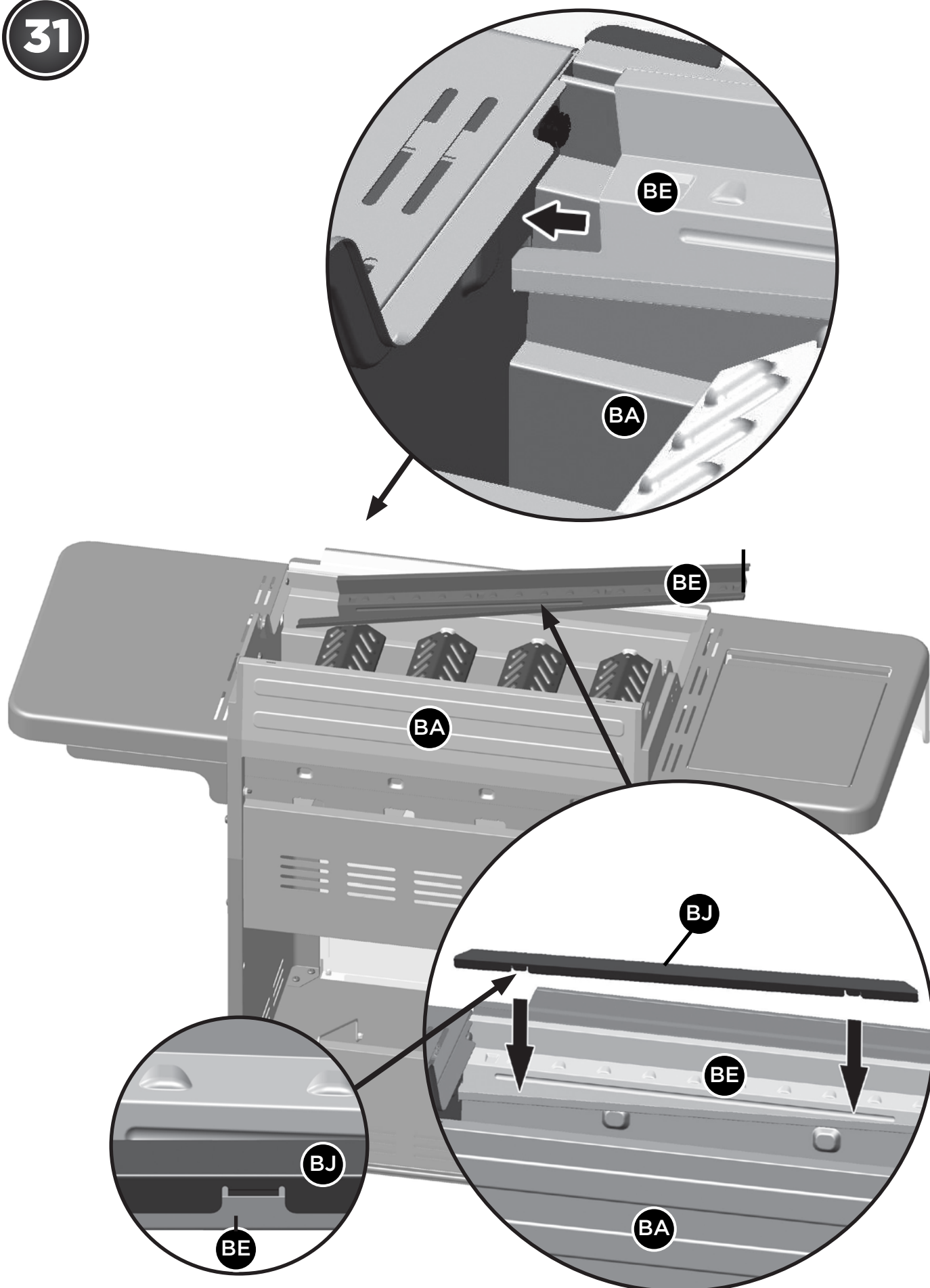

32

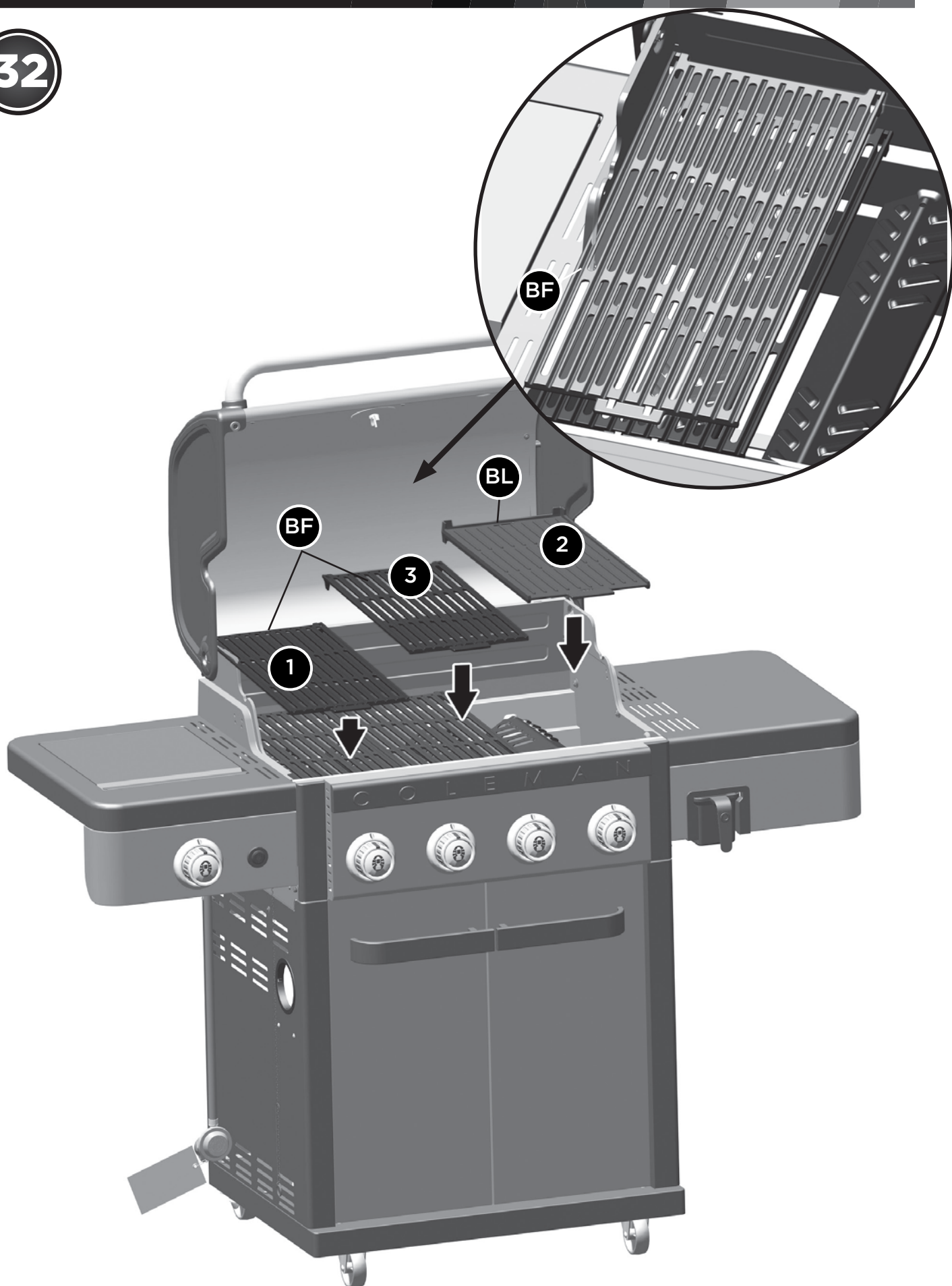

33

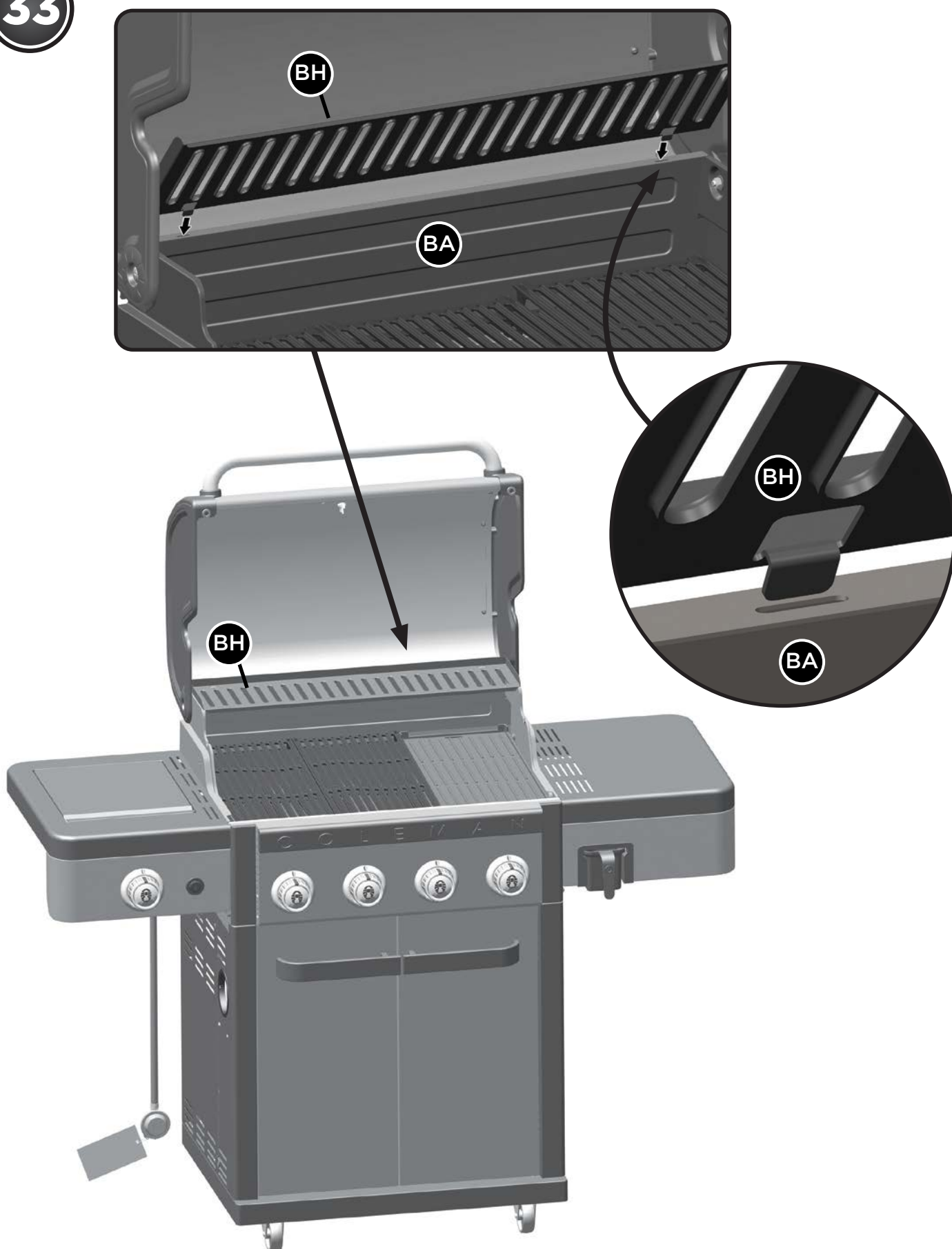

34

FOR PROPANE MODEL ONLY



⚠ ATTENTION:
DO NOT STORE EXTRA PROPANE
TANK WITHIN BBQ CART.

ADDITIONAL WARNINGS

You have now completed the Assembly of your COLEMAN® REVOLUTION™ BARBECUE.

NEXT STEPS:

1. Position your BARBECUE
2. Read SAFE USE & CARE MANUAL
3. Perform Grill Safety Check-list

⚠ **WARNING:**

FOR YOUR FAMILY'S SAFETY, DO NOT ATTEMPT TO LIGHT THIS BBQ UNTIL YOU HAVE REVIEWED PAGES 4-7 OF THE COLEMAN® SAFE USE & CARE MANUAL. ALL SAFETY AND LEAK TESTS MUST BE PERFORMED BY THE END USER, PRIOR TO LIGHTING THIS BBQ.

⚠ **WARNING HOT SURFACES:**

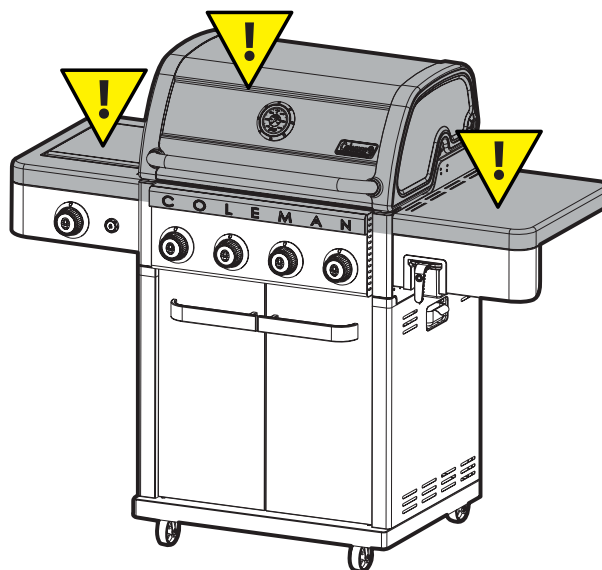

POSITION YOUR BARBECUE

Always confirm that this Barbecue is not positioned under a combustible object (e.g., an awning or umbrella) or in a covered area (e.g., porch or gazebo) before lighting it, to prevent a possible fire.

Always confirm that this Barbecue is not positioned under the overhang of a house, a garage or other structure before lighting it. An overhang will serve to deflect flare-ups and radiate heat into the structure itself, which could result in a fire.



Always confirm that this Barbecue is positioned more than 36" (91.4cm) away from any combustible materials or surfaces before lighting it, and that no gasoline or other volatile substances are stored in the vicinity of this Barbecue. The temperature of a grease fire or of the radiated heat might otherwise be sufficient to ignite nearby combustibles or volatile substances. Do not position near windows, siding, or fencing.

Always locate the Barbecue where there will be ample combustion and ventilation air, but never position it in the direct path of a strong wind.

Level your barbecue for optimal performance of Flare-Free Technology™.



©2023 The Coleman Company, Inc.

Coleman®,  and  are registered trademarks of
The Coleman Company, Inc. used under license.